

# CT47 ULTRA-RUGGED MOBILE COMPUTER

Configuration Guide



SCAN HANDLE



RFID



VEHICLE DOCK



CT47



CT47 NI  
NON-INCENDIVE  
ATEX / IEC Ex

THE  
FUTURE  
IS  
WHAT  
WE  
MAKE IT

Honeywell

# TABLE OF CONTENTS

- 1** **TABLE OF CONTENTS**
  
- 2** **CT47 FEATURE OVERVIEW**
  - S0703 STANDARD RANGE
  - N6803 FLEXRANGE™ NEAR/ FAR RANGE
  - S0803 FLEXRANGE™ XLR NEAR/ EXTRA LONG RANGE
  - NON-INCENDIVE / ATEX / IEC EX - S0803 FLEXRANGE™ XLR NEAR/ EXTRA LONG RANGE
  
- 6** **CT47 CONFIGURATION MAP**
  - ANDROID
  
- 7** **HONEYWELL EDGE SERVICES**
  - GOLD REPAIR SERVICES - 3 YEAR
  - PLATINUM REPAIR SERVICES - 3 YEAR
  - GOLD REPAIR SERVICES - 5 YEAR
  - PLATINUM REPAIR SERVICES - 5 YEAR
  - CT47 - REPAIR SERVICES COVERAGE
  
- 10** **CT47 SOFTWARE**
  - DEVICE CLIENT PACK
  
- 11** **CT47 SCANNING**
  - SCAN HANDLE SIDE BY SIDE COMPARISON
  - OPTION 1 - SCAN HANDLE
  - OPTION 2 - SCAN HANDLE WITH PROTECTIVE BOOT
  - DOCKABLE PROTECTIVE BOOT
  
- 15** **CT47 DESKTOP COMMUNICATIONS**
  - OPTION 1 – PORTABLE - NON-BOOTED OR BOOTED
  - OPTION 2 – FIXED WITH UNIVERSAL CUP
  - OPTION 3 – USB TYPE C ON-THE-GO (OTG) DESKTOP
  - OPTION 4 – USB TYPE C ON-THE-GO (OTG) VEHICLE
  - OPTION 5 - DISPLAY BASE WITH UNIVERSAL CUP
  
- 18** **CT47 VEHICLE INSTALL**
  - OPTION 1 – PORTABLE/ SUB CONTRACTOR INSTALL
  - OPTION 2 – PORTABLE/ SUB CONTRACTOR INSTALL
  - OPTION 3 - FIXED VEHICLE INSTALL WITH DIRECT CONNECTION TO VEHICLE BATTERY
  - OPTION 4 - FIXED VEHICLE INSTALL WITH DIRECT CONNECTION TO VEHICLE BATTERY - EXTERNAL SPEAKER
  - OPTION 5 - FIXED VEHICLE INSTALL WITH DIRECT CONNECTION TO VEHICLE BATTERY/ FUSE BLOCK
  - OPTION 6 - FIXED VEHICLE INSTALL WITH DIRECT CONNECTION TO VEHICLE BATTERY/ FUSE BLOCK  
– EXTERNAL SPEAKER
  - OPTION 7 - FIXED VEHICLE INSTALL WITH THOR DC/DC CONVERTER
  - OPTION 8 - FIXED VEHICLE INSTALL WITH THOR DC/DC CONVERTER - EXTERNAL SPEAKER
  - CT45/ CT47 VEHICLE DOCK (CT45-VD-CNV) DETAIL VIEW - NON-BOOTED
  - CT45/ CT47 VEHICLE DOCK (CT45-VD-CNV) DETAIL VIEW - BOOTED
  - CT45/ CT47 VEHICLE DOCK WITH EXTERNAL SPEAKER (CT45-VD-CNV-SPK) DETAIL VIEW - NON-BOOTED
  - CT45/ CT47 VEHICLE DOCK WITH EXTERNAL SPEAKER (CT45-VD-CNV-SPK) DETAIL VIEW - BOOTED
  
- 29** **CT47 CHARGING AND COMMUNICATION**
  - OPTION 1 - NON-BOOTED QUAD CHARGER WITH UNIVERSAL CUP
  - OPTION 2 - BOOTED QUAD CHARGER WITH UNIVERSAL CUP
  - OPTION 3 - NON-BOOTED 5-BAY CHARGER WITH BATTERY CUP
  - OPTION 4 - BOOTED 5-BAY CHARGER WITH BATTERY CUP
  - OPTION 5 - NON-BOOTED 5-BAY CHARGER WITH UNIVERSAL CUPS
  - OPTION 6 - BOOTED 5-BAY CHARGER WITH UNIVERSAL CUPS
  - OPTION 7 - QUAD BATTERY CHARGER
  - OPTION 8 - 1-BAY QUAD BATTERY CHARGER WITH UNIVERSAL CUP
  
- 33** **CT47 CHARGING AND COMMUNICATION**
  - RACK / WALL MOUNT BRACKET
  
- 34** **CT47 BATTERY**
  - SPARE BATTERY OPTIONS
  
- 35** **CT47 RFID**
  - IH40 RFID READER WITH CT47 NON-BOOTED
  - IH40 RFID READER WITH CT47 BOOTED
  
- 37** **CT47 RFID CHARGING**
  - OPTION 1 - IH40 NON-BOOTED QUAD CHARGER
  - OPTION 2 - IH40 BOOTED QUAD CHARGER
  - OPTION 3 - IH40 QUAD BATTERY CHARGER
  
- 39** **CT47 HEADSET**
  - USB-C CT47 PUSH TO TALK (PTT) HEADSET
  
- 40** **MISCELLANEOUS**
  - OPTIONAL PARTS
  - MICRO-SD CARDS
  - AC CORDS

# CT47 FEATURE OVERVIEW

## S0703 Standard Range

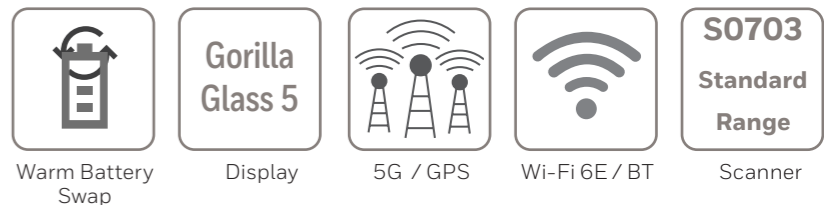

Included in the box:

- CT47 Mobile Computer
- Battery (CT4X-BTSC-001)
- USB Type C cable
- Hand strap
- SIM/SD Card Cover Screw

(Stylus is NOT included, but available to order separately as an accessory)



S0703 Standard Range



### CT47 Android - 5G WWAN - S0703 - 8GB RAM/ 128GB Flash

#### CT47-X1N-57D1E0G

CT47, 5G WWAN, 5.5 inch Display, Wi-Fi 6E 802.11 a/b/g/n/ac/d/h/i/r/k/v/w/mc/ax, 2x2 MU-MIMO, BT5.2 & 2nd BLE, 8GB RAM/128GB Flash, S0703 Standard Range, 13MP Rear Camera / 8MP Front Camera, Fingerprint Sensor, Android (GMS), Device Client Pack (DCP) Pre-Loaded (1 Year DCP Term License), 1 x Nano SIM & 1 x eSIM, Standard, 4,775mAh Standard Battery, Global

#### CT47-X1N-37D1E0G

### CT47 Android - 5G WWAN - S0703 - 6GB RAM/ 128GB Flash

CT47, 5G WWAN, 5.5 inch Display, Wi-Fi 6E 802.11 a/b/g/n/ac/d/h/i/r/k/v/w/mc/ax, 2x2 MU-MIMO, BT5.2 & 2nd BLE, 6GB RAM/128GB Flash, S0703 Standard Range, 13MP Rear Camera / 8MP Front Camera, Fingerprint Sensor, Android (GMS), Device Client Pack (DCP) Pre-Loaded (1 Year DCP Term License), 1 x Nano SIM & 1 x eSIM, Standard, 4,775mAh Standard Battery, Global

### CT47 Android - Wi-Fi Only - S0703 - 8GB RAM/ 128GB Flash

#### CT47-X0N-57D100G

CT47, WLAN, 5.5 inch Display, Wi-Fi 6E 802.11 a/b/g/n/ac/d/h/i/r/k/v/w/mc/ax, 2x2 MU-MIMO, BT5.2 & 2nd BLE, 8GB RAM/128GB Flash, S0703 Standard Range, 13MP Rear Camera / 8MP Front Camera, Fingerprint Sensor, Android (GMS), Device Client Pack (DCP) Pre-Loaded (1 Year DCP Term License), Standard, 4,775mAh Standard Battery, Global

#### CT47-X0N-37D100G

### CT47 Android - Wi-Fi Only - S0703 - 6GB RAM/ 128GB Flash

CT47, WLAN, 5.5 inch Display, Wi-Fi 6E 802.11 a/b/g/n/ac/d/h/i/r/k/v/w/mc/ax, 2x2 MU-MIMO, BT5.2 & 2nd BLE, 6GB RAM/128GB Flash, S0703 Standard Range, 13MP Rear Camera / 8MP Front Camera, Fingerprint Sensor, Android (GMS), Device Client Pack (DCP) Pre-Loaded (1 Year DCP Term License), Standard, 4,775mAh Standard Battery, Global

### Honeywell Repair Services

SVCCT47-SG3N

CT47, Edge Service, Gold Maintenance Contract, 3 Year, New Contract

ADD SVCREPLACE-MOB3

AddOn, Edge Service, Device Replacement, Mobility, 3 Year

# CT47 FEATURE OVERVIEW

## N6803 FlexRange™ Near/ Far Range

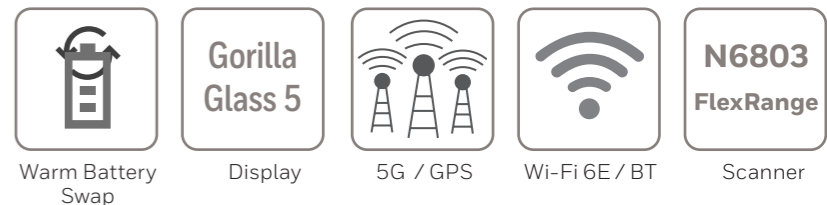

Included in the box:

- CT47 Mobile Computer
- Battery (CT4X-BTSC-001)
- USB Type C cable
- Hand strap
- SIM/SD Card Cover Screw

(Stylus is NOT included, but available to order separately as an accessory)



N6803 FlexRange™

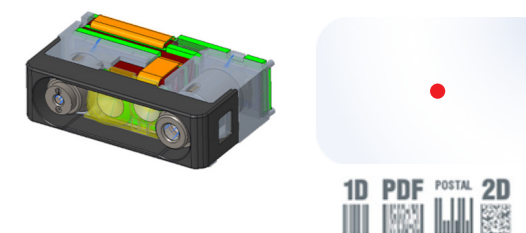

### CT47 Android - 5G WWAN - N6803 - 8GB RAM/ 128GB Flash

#### CT47-X1N-58D1EOG

CT47, 5G WWAN, 5.5 inch Display, Wi-Fi 6E 802.11 a/b/g/n/ac/d/h/i/r/k/v/w/mc/ax, 2x2 MU-MIMO, BT5.2 & 2nd BLE, 8GB RAM/128GB Flash, N6803 FlexRange, 13MP Rear Camera / 8MP Front Camera, Fingerprint Sensor, Android (GMS), Device Client Pack (DCP) Pre-Loaded (1 Year DCP Term License), 1 x Nano SIM & 1 x eSIM, Standard, 4,775mAh Standard Battery, Global

### CT47 Android - Wi-Fi Only - N6803 - 8GB RAM/ 128GB Flash

#### CT47-X0N-58D100G

CT47, WLAN, 5.5 inch Display, Wi-Fi 6E 802.11 a/b/g/n/ac/d/h/i/r/k/v/w/mc/ax, 2x2 MU-MIMO, BT5.2 & 2nd BLE, 8GB RAM/128GB Flash, N6803 FlexRange, 13MP Rear Camera / 8MP Front Camera, Fingerprint Sensor, Android (GMS), Device Client Pack (DCP) Pre-Loaded (1 Year DCP Term License), Standard, 4,775mAh Standard Battery, Global

### CT47 Android - 5G WWAN - N6803 - 6GB RAM/ 128GB Flash

#### CT47-X1N-38D1EOG

CT47, 5G WWAN, 5.5 inch Display, Wi-Fi 6E 802.11 a/b/g/n/ac/d/h/i/r/k/v/w/mc/ax, 2x2 MU-MIMO, BT5.2 & 2nd BLE, 6GB RAM/128GB Flash, N6803 FlexRange, 13MP Rear Camera / 8MP Front Camera, Fingerprint Sensor, Android (GMS), Device Client Pack (DCP) Pre-Loaded (1 Year DCP Term License), 1 x Nano SIM & 1 x eSIM, Standard, 4,775mAh Standard Battery, Global

### CT47 Android - Wi-Fi Only - N6803 - 6GB RAM/ 128GB Flash

#### CT47-X0N-38D100G

CT47, WLAN, 5.5 inch Display, Wi-Fi 6E 802.11 a/b/g/n/ac/d/h/i/r/k/v/w/mc/ax, 2x2 MU-MIMO, BT5.2 & 2nd BLE, 6GB RAM/128GB Flash, N6803 FlexRange, 13MP Rear Camera / 8MP Front Camera, Fingerprint Sensor, Android (GMS), Device Client Pack (DCP) Pre-Loaded (1 Year DCP Term License), Standard, 4,775mAh Standard Battery, Global

### Honeywell Repair Services

SVCCT47-SG3N

CT47, Edge Service, Gold Maintenance Contract, 3 Year, New Contract

ADD SVCREPLACE-MOB3

AddOn, Edge Service, Device Replacement, Mobility, 3 Year

# CT47 FEATURE OVERVIEW

## S0803 FlexRange™ XLR Near/ Extra Long Range



Included in the box:

- CT47 Mobile Computer
- Battery (CT4X-BTSC-001)
- USB Type C cable
- Hand strap
- SIM/SD Card Cover Screw

(Stylus is NOT included, but available to order separately as an accessory)



S0803 FlexRange™ XLR



### CT47 Android - 5G WWAN - S0803 - 8GB RAM/ 128GB Flash

#### CT47-X1N-5ED1EOG

CT47, 5G WWAN, 5.5 inch Display, Wi-Fi 6E 802.11 a/b/g/n/ac/d/h/i/r/k/v/w/mc/ax, 2x2 MU-MIMO, BT5.2 & 2nd BLE, 8GB RAM/128GB Flash, S0803 FlexRange XLR, 13MP Rear Camera / 8MP Front Camera, Fingerprint Sensor, Android (GMS), Device Client Pack (DCP) Pre-Loaded (1 Year DCP Term License), 1 x Nano SIM & 1 x eSIM, Standard, 4,775mAh Standard Battery, Global

### CT47 Android - 5G WWAN - S0803 - 6GB RAM/ 128GB Flash

#### CT47-X1N-3ED1EOG

CT47, 5G WWAN, 5.5 inch Display, Wi-Fi 6E 802.11 a/b/g/n/ac/d/h/i/r/k/v/w/mc/ax, 2x2 MU-MIMO, BT5.2 & 2nd BLE, 6GB RAM/128GB Flash, S0803 FlexRange XLR, 13MP Rear Camera / 8MP Front Camera, Fingerprint Sensor, Android (GMS), Device Client Pack (DCP) Pre-Loaded (1 Year DCP Term License), 1 x Nano SIM & 1 x eSIM, Standard, 4,775mAh Standard Battery, Global

### CT47 Android - Wi-Fi Only - S0803 - 8GB RAM/ 128GB Flash

#### CT47-X0N-5ED100G

CT47, WLAN, 5.5 inch Display, Wi-Fi 6E 802.11 a/b/g/n/ac/d/h/i/r/k/v/w/mc/ax, 2x2 MU-MIMO, BT5.2 & 2nd BLE, 8GB RAM/128GB Flash, S0803 FlexRange XLR, 13MP Rear Camera / 8MP Front Camera, Fingerprint Sensor, Android (GMS), Device Client Pack (DCP) Pre-Loaded (1 Year DCP Term License), Standard, 4,775mAh Standard Battery, Global

### CT47 Android - Wi-Fi Only - S0803 - 6GB RAM/ 128GB Flash

#### CT47-X0N-3ED100G

CT47, WLAN, 5.5 inch Display, Wi-Fi 6E 802.11 a/b/g/n/ac/d/h/i/r/k/v/w/mc/ax, 2x2 MU-MIMO, BT5.2 & 2nd BLE, 6GB RAM/128GB Flash, S0803 FlexRange XLR, 13MP Rear Camera / 8MP Front Camera, Fingerprint Sensor, Android (GMS), Device Client Pack (DCP) Pre-Loaded (1 Year DCP Term License), Standard, 4,775mAh Standard Battery, Global

### Honeywell Repair Services

SVCCT47-SG3N

CT47, Edge Service, Gold Maintenance Contract, 3 Year, New Contract

ADD SVCREPLACE-MOB3

AddOn, Edge Service, Device Replacement, Mobility, 3 Year

# CT47 FEATURE OVERVIEW

## Non-Incendive / ATEX / IEC Ex - S0803 FlexRange™ XLR Near/ Extra Long Range



Included in the box:

- CT47 Mobile Computer
- Battery (CT4X-BTSC-001)
- USB Type C cable
- Hand strap
- SIM/SD Card Cover Screw

(Stylus is NOT included, but available to order separately as an accessory)



S0803 FlexRange™ XLR



### CT47 Android - 5G WWAN - S0803 - 8GB RAM/ 128GB Flash

#### CT47-X1N-5ED1E1G

CT47, 5G WWAN, 5.5 inch Display, Wi-Fi 6E 802.11 a/b/g/n/ac/d/h/i/r/k/v/w/mc/ax, 2x2 MU-MIMO, BT5.2 & 2nd BLE, 8GB RAM/128GB Flash, S0803 FlexRange XLR, 13MP Rear Camera / 8MP Front Camera, Fingerprint Sensor, Android (GMS), Device Client Pack (DCP) Pre-Loaded (1 Year DCP Term License), 1 x Nano SIM & 1 x eSIM, Non-Incendive (NI) / ATEX / IEC Ex, 4,775mAh NI/ATEX/IECEX Battery, Global

#### Honeywell Repair Services

SVCCT47-SG3N



CT47, Edge Service, Gold Maintenance Contract, 3 Year, New Contract

ADD SVCREPLACE-MOB3

AddOn, Edge Service, Device Replacement, Mobility, 3 Year

# CT47 CONFIGURATION MAP

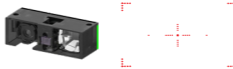
## Android

|              | BLUETOOTH/ WI-FI | WWAN     | NFC      | MEMORY   | IMAGER   | CAMERA   | OPERATING SYSTEM | SIM | OPTIONS | DOMAIN | DESCRIPTION   | NOTES   |
|--------------|------------------|----------|----------|----------|----------|----------|------------------|-----|---------|--------|---|---|
| <b>CT47-</b> |                  |          |          |          |          |          |                  |     |         |        |   |   |
|              | <b>X</b>         |          |          |          |          |          |                  |     |         |        | Wi-Fi 6E 802.11 a/b/g/n/ac/mc/ax, 2x2 MU-MIMO + Bluetooth 5.2 | IEEE 802.11 a/b/g/n/ac/d/h/i/r/k/v/w/mc/ax, 2x2 MU-MIMO ; Wi-Fi certified, Wi-Fi 6E certified<br>Bluetooth V5.2 and BLE Supported<br>Bluetooth Profiles: HFP, PBAP, A2DP, AVRCP, OPP, SPP, GATT   |
|              |                  | <b>0</b> |          |          |          |          |                  |     |         |        | No WWAN   |   |
|              |                  | <b>1</b> |          |          |          |          |                  |     |         |        | 5G, LTE (4G) GPS, UMTS/HSPA+ (3G) GSM/GPRS/EDGE               | WWAN RADIO (ATT/VZW/SPRINT/TMO/NA/EU)<br>5G FR1 - BANDS 1,2,3,4,5,7,8,12,14,20,25,28,30,38,40,41,48,66,71,77,78,79<br>LTE - BANDS 1,2,3,4,5,7,8,12,13,14,17,18,19,20,25,26,28,29,30,32,38,39,40,41,42,43,66,71<br>UMTS/HSPA+ (3G) - BANDS 1, 2, 4, 5, 6, 8, 9, 19 / GSM/GPRS/EDGE QUAD-BAND (850/900/1800/1900 MHZ)   |
|              |                  |          | <b>N</b> |          |          |          |                  |     |         |        | Near Field Communications (NFC)                               | Integrated NFC reader, compliant with ISO/IEC 14443 A, ISO/IEC 14443 B, ISO/IEC 15693 (iCode), MIFARE 1K / 4K, MIFARE DESFire, Sony FeliCa, ISO/IEC 18092 (Type F)  |
|              |                  |          | --       |          |          |          |                  |     |         |        |   |   |
|              |                  |          |          | <b>3</b> |          |          |                  |     |         |        | 6GB RAM, 128GB Flash Memory                                   | Qualcomm QCS6490/QCM6490 octa-core, 2.7GHz  |
|              |                  |          |          | <b>5</b> |          |          |                  |     |         |        | 8GB RAM, 128GB Flash Memory                                   | Qualcomm QCS6490/QCM6490 octa-core, 2.7GHz  |
|              |                  |          |          |          | <b>7</b> |          |                  |     |         |        | 1D/2D Imager (S0703SR) – Standard Range                       |   |
|              |                  |          |          |          | <b>8</b> |          |                  |     |         |        | 1D/2D Imager (N6803FR) – FlexRange™                           |    |
|              |                  |          |          |          | <b>E</b> |          |                  |     |         |        | 1D/2D Imager (S0803) – FlexRange™ XLR                         |    |
|              |                  |          |          |          | <b>D</b> |          |                  |     |         |        | 13MP Rear Camera / 8MP Front Camera                           |   |
|              |                  |          |          |          |          | <b>1</b> |                  |     |         |        | Android (GMS)   | Google Mobile Services (GMS) certified – Play Store   |
|              |                  |          |          |          |          | <b>2</b> |                  |     |         |        | Android (Non-GMS)   |   |
|              |                  |          |          |          |          | <b>0</b> |                  |     |         |        | No SIM slot   |   |
|              |                  |          |          |          |          | <b>E</b> |                  |     |         |        | 1 x eSIM & 1 x Nano SIM Slot                                  |   |
|              |                  |          |          |          |          | <b>0</b> |                  |     |         |        | Standard  |   |
|              |                  |          |          |          |          | <b>1</b> |                  |     |         |        | Non-Incendive (NI) / ATEX / IEC Ex                            |   |
|              |                  |          |          |          |          |          | <b>G</b>         |     |         |        | Global (WWAN or Wi-Fi)  | Algeria, Argentina, Australia, Austria, Belarus, Belgium, Bolivia, Brazil, Canada, Chile, Colombia, Costa Rica, Croatia, Czech Republic, Denmark, Dominican Republic, Ecuador, Egypt, Estonia, Finland, France, Germany, Greece, Guatemala, Hong Kong, Hungary, India, Ireland, Israel, Italy, Japan, Lithuania, Malaysia, Mexico, Morocco, Netherlands, New Zealand, Norway, Peru, Philippines, Poland, Portugal, Romania, Russian Fed., Saudi Arabia, Serbia, Singapore, Slovakia, Slovenia, South Africa, South Korea, Spain, Sweden, Switzerland, Taiwan, Thailand, Tunisia, Turkey, UAE, Ukraine, United Kingdom, United States of America |



# HONEYWELL EDGE SERVICES

## CT47 – Repair Services

Honeywell Edge Services give you the confidence of having leading-class technologies combined with service and support plans that are designed to keep you operational for longer.

For a full description of maintenance services, including terms and conditions, please see <https://sps.honeywell.com/us/en/services/productivity/support-services/maintenance-services>

### Gold Repair Services – 3 Year

The Edge Services Gold Support contract allows flexibility for you to select the right coverage for your organization, including 5-Day Depot Repairs and:

#### Service Overview

- Repair or replacement (at Honeywell discretion) for damaged components, wear and tear, accidental damage
- Flexibility to add any Add-On Service
- Android Service - includes Android OS Upgrades, Maintenance Releases and Security Patches

| PART NUMBER  | DESCRIPTION   |
|--------------|---|
| SVCCT47-SG3N | CT47, Edge Service, GOLD Maintenance Contract, 5 Day Turnaround, <b>3 Year</b> , New Contract |

#### Add-On Accessory Replacement Service

Provides replacement chargers, docks, charging cables, or scan handles should they be damaged or stop working.

|                        |  |
|------------------------|--|
| <b>ADD</b> SVCACC-MOB3 | AddOn, Edge Service, Accessory Service , Mobility, <b>3 Year</b> . Service covers docks, charger cradles, scan handles |
|------------------------|--|

#### Add-On Battery Replacement Service

Provides replacement batteries as needed after a minimum of 18 months post-purchase.

|                            |   |
|----------------------------|---|
| <b>ADD</b> SVCBATTERY-MOB3 | AddOn, Edge Service, Battery Service, Mobility, <b>3 Year</b> , 1 Replacement Battery over life of contract |
|----------------------------|---|

#### Add-On Device Replacement Service

Replacement devices should a device be damaged beyond repair.

|                            |  |
|----------------------------|--|
| <b>ADD</b> SVCREPLACE-MOB3 | AddOn, Edge Service, Device Replacement, Mobility, <b>3 Year</b> |
|----------------------------|--|

#### Add-On Image Management Service

Ensures that when a device returns from being repaired, it has all the proper applications loaded back on the device.

|                              |   |
|------------------------------|---|
| <b>ADD</b> SVCIMAGEMGMT-MOB3 | AddOn, Edge Service, Image Service, Mobility, <b>3 Year</b> |
|------------------------------|---|

#### Add-On Spare Management Service

Manages your spare pool.

|                              |   |
|------------------------------|---|
| <b>ADD</b> SVCSPAREMGMT-MOB3 | AddOn, Edge Service, Advanced Exchange, Mobility, <b>3 Year</b> . Customer owned spare pool, Minimum Purchase required, contact your local Honeywell Service Representative for more information. |
|------------------------------|---|

#### Add-On 2-Day Turnaround Depot Upgrade

Upgrade your Gold Maintenance Contract from 5-Day to 2-Day turnaround at the repair depot.

|                              |   |
|------------------------------|---|
| <b>ADD</b> SVC2DAYDEPOT-MOB3 | AddOn, Edge Service, 2-Day Depot Upgrade, 3-Year Agreement, Requires purchase of a <b>3 Year</b> Gold Maintenance Contract. |
|------------------------------|---|

### Platinum Repair Services – 3 Year

The Edge Services Platinum Support contract offers 2-Day Depot Repairs or Spare Pool Management with 3 year contract that includes:

#### Service Overview

- Repair or replacement (at Honeywell discretion) for damaged components, wear and tear, accidental damage
- SVCREPLACE-MOB3 - Replacement devices should a device be damaged beyond repair
- SVCACC-MOB3 - Accessory replacement service
- SVCBATTERY-MOB3 - Battery replacement service
- SVCSPAREMGMT-MOB3 - Spare pool management (optional, minimum quantity required)
- Telephone-based technical support
- Android Service - includes Android OS Upgrades, Maintenance Releases and Security Patches

| PART NUMBER  | DESCRIPTION  |
|--------------|--|
| SVCCT47-SP3N | CT47, Edge Service, PLATINUM, 2 Day Turnaround, <b>3 Year</b> , New Contract |





# HONEYWELL EDGE SERVICES

## CT47 – Repair Services

Honeywell Edge Services give you the confidence of having leading-class technologies combined with service and support plans that are designed to keep you operational for longer.

For a full description of maintenance services, including terms and conditions, please see <https://sps.honeywell.com/us/en/services/productivity/support-services/maintenance-services>

### Gold Repair Services – 5 Year

The Edge Services Gold Support contract allows flexibility for you to select the right coverage for your organization, including 5-Day Depot Repairs and:

#### Service Overview

- Repair or replacement (at Honeywell discretion) for damaged components, wear and tear, accidental damage
- Flexibility to add any Add-On Service
- Android Service - includes Android OS Upgrades, Maintenance Releases and Security Patches

| PART NUMBER  | DESCRIPTION   |
|--------------|---|
| SVCCT47-SG5N | CT47, Edge Service, GOLD Maintenance Contract, 5 Day Turnaround, <b>5 Year</b> , New Contract |

#### Add-On Accessory Replacement Service

Provides replacement chargers, docks, charging cables, or scan handles should they be damaged or stop working.

|                        |  |
|------------------------|--|
| <b>ADD</b> SVCACC-MOB5 | AddOn, Edge Service, Accessory Service , Mobility, <b>5 Year</b> . Service covers docks, charger cradles, scan handles |
|------------------------|--|

#### Add-On Battery Replacement Service

Provides replacement batteries as needed after a minimum of 18 months post-purchase.

|                            |   |
|----------------------------|---|
| <b>ADD</b> SVCBATTERY-MOB5 | AddOn, Edge Service, Battery Service, Mobility, <b>5 Year</b> , 2 Replacement Battery over life of contract |
|----------------------------|---|

#### Add-On Device Replacement Service

Replacement devices should a device be damaged beyond repair.

|                            |  |
|----------------------------|--|
| <b>ADD</b> SVCREPLACE-MOB5 | AddOn, Edge Service, Device Replacement, Mobility, <b>5 Year</b> |
|----------------------------|--|

#### Add-On Image Management Service

Ensures that when a device returns from being repaired, it has all the proper applications loaded back on the device.

|                              |   |
|------------------------------|---|
| <b>ADD</b> SVCIMAGEMGMT-MOB5 | AddOn, Edge Service, Image Service, Mobility, <b>5 Year</b> |
|------------------------------|---|

#### Add-On Spare Management Service

Manages your spare pool.

|                              |   |
|------------------------------|---|
| <b>ADD</b> SVCSPAREMGMT-MOB5 | AddOn, Edge Service, Advanced Exchange, Mobility, <b>5 Year</b> . Customer owned spare pool, Minimum Purchase required, contact your local Honeywell Service Representative for more information. |
|------------------------------|---|

#### Add-On 2-Day Turnaround Depot Upgrade

Upgrade your Gold Maintenance Contract from 5-Day to 2-Day turnaround at the repair depot.

|                              |   |
|------------------------------|---|
| <b>ADD</b> SVC2DAYDEPOT-MOB5 | AddOn, Edge Service, 2-Day Depot Upgrade, 5-Year Agreement, Requires purchase of a <b>5 Year</b> Gold Maintenance Contract. |
|------------------------------|---|

### Platinum Repair Services – 5 Year

The Edge Services Platinum Support contract offers 2-Day Depot Repairs or Spare Pool Management with 5 year contract that includes:

#### Service Overview

- Repair or replacement (at Honeywell discretion) for damaged components, wear and tear, accidental damage
- SVCREPLACE-MOB5 - Replacement devices should a device be damaged beyond repair
- SVCACC-MOB5 - Accessory replacement service
- SVCBATTERY-MOB5 - Battery replacement service
- SVCSPAREMGMT-MOB5 - Spare pool management (optional, minimum quantity required)
- Telephone-based technical support
- Android Service - includes Android OS Upgrades, Maintenance Releases and Security Patches

| PART NUMBER  | DESCRIPTION  |
|--------------|--|
| SVCCT47-SP5N | CT47, Edge Service, PLATINUM, 2 Day Turnaround, <b>5 Year</b> , New Contract |



# HONEYWELL REPAIR SERVICES

## CT47 - Repair Services Coverage

Service options tailored to customer requirements

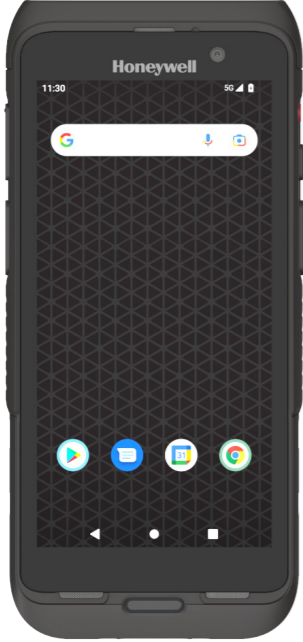

CT47

Warranty Cover Against Product Defect

**BASIC Service**

**Gold Coverage:**

- Accidental Damage
- Wear & Tear
- Android Service

Includes Replacement of:

- Handstrap
- Screen Protector



Flexible GOLD Add-Ons ordered separately

- SVCACC-MOB3      Accessories
- SVCBATTERY-MOB3      Batteries
- SVCREPLACE-MOB3      Device Replacement
- SVCIMAGEMGMT-MOB3      Image Service
- SVCSPAREMGMT-MOB3      Advanced Exchange

**GOLD Service**

**Platinum Coverage**

- Battery Replacement
- Coverage for Docks/ Chargers
- Android Service

- Accidental Damage
- Device Replacement
- Wear & Tear



Pistol Grip



Vehicle Dock



Car Chargers



Battery  
(3 Year – 1 replacement battery per CT47)  
(5 Year – 2 replacement batteries per CT47)



Docks



Dock Power Supplies

**PLATINUM Service**

| COVERAGE        | PART NUMBER       | DESCRIPTION   |
|-----------------|-------------------|---|
| <b>BASIC</b>    | SVCCT47-EXW2      | CT47, BASIC, 10-15 Day Turnaround, 2 Years (1 Year Factory Warranty + 1 Year Extended)  |
| <b>GOLD</b>     | SVCCT47-SG3N      | CT47, Edge Service, GOLD Maintenance Contract, 5 Day Turnaround, 3 Year, New Contract   |
| <b>ADD</b>      | SVCACC-MOB3       | AddOn, Edge Service, Accessory Service, Mobility, 3 Year. Service covers docks, charger cradles, scan handles and car adapter |
| <b>ADD</b>      | SVCBATTERY-MOB3   | AddOn, Edge Service, Battery Service, Mobility, 3 Year, 1 Replacement Battery over life of contract                           |
| <b>ADD</b>      | SVCREPLACE-MOB3   | AddOn, Edge Service, Device Replacement, Mobility, 3 Year   |
| <b>ADD</b>      | SVCIMAGEMGMT-MOB3 | AddOn, Edge Service, Image Service, Mobility, 3 Year  |
| <b>ADD</b>      | SVCSPAREMGMT-MOB3 | AddOn, Edge Service, Advanced Exchange, Mobility, 3 Year. Customer owned spare pool, Minimum Purchase required.               |
| <b>PLATINUM</b> | SVCCT47-SP3N      | CT47, Edge Service, PLATINUM, 2 Day Turnaround, 3 Year, New Contract  |

# CT47 SOFTWARE

## Device Client Pack

The Device Client Pack (DCP) includes Launcher, Enterprise Browser, BasicTE, and Mobility Web SDK, these applications are pre-loaded on the device.

All CT47 units include a 1 Year DCP Termed Pre-License for initial evaluation of the DCP applications (it does NOT include a Perpetual Pre-License), after the 1 Year Term period expires, a Perpetual or Term license is required to be purchased.

There are two licensing options that can be purchased for DCP:

1. Perpetual License Purchase DCP-001 - Perpetual Licenses operate without expiration for the authorized software version features, and includes 1 year of Maintenance. Add additional Software Maintenance separately.
2. Term + Maintenance License Purchase DCP-SFT1, DCP-SFT2, DCP-SFT3, DCP-SFT4 or DCP-SFT5 - Term + Maintenance Licenses provide software operation, software new version features, and tech support, all for a defined period.

### Device Client Pack



Launcher



Launcher - gives the customer total control over which apps can be run on the device.



BasicTE

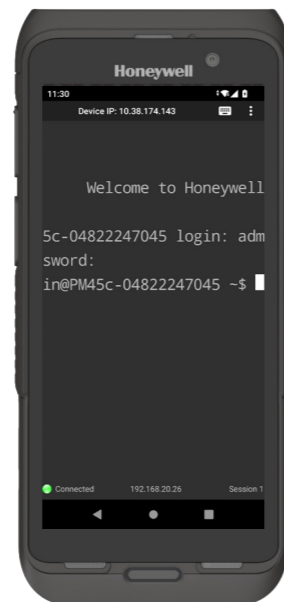

BasicTE Android device Terminal Emulation is a simplified alternative for those not yet ready to upgrade to SmartTE.



Enterprise Browser



Enterprise Browser provides corporations the ability to run standard web applications from a controlled environment.

### Order Separately



SmartTE Terminal Emulator



Terminal Emulator - Full featured SmartTE allows legacy green screen apps to be transformed to the look and feel of native apps. These clients are single session Honeywell TE Licensing. They can also utilize traditional single or multi-session StayLinked Licenses.

SmartTE is Pre-Loaded, but requires license SMARTTE-001 to be purchased separately.

| PART NUMBER      | DESCRIPTION   |
|------------------|---|
| SMARTTE-001      | SmartTE Single path initial license. Includes 1 Year maintenance.   |
| SMARTTE-SFT3     | SMARTTE - 3 Year Software Maintenance   |
| SMARTTE-SFT5     | SMARTTE - 5 Year Software Maintenance   |
| SMARTTE-SND-SFT1 | SMARTTE - High availability secondary backup or development server, includes 1 Year maintenance. Not for primary server. Purchase one per device. |

| PART NUMBER | DESCRIPTION  |
|-------------|--|
| DCP-001     | Device Client Pack Perpetual License (DCP) includes 1 Year Software Maintenance. License covers Launcher, Enterprise Browser, BasicTE, and Mobility Web SDK. Purchase additional years of Software Maintenance DCP-SFT1, DCP-SFT2, DCP-SFT3, DCP-SFT4 or DCP-SFT5 prior to maintenance expiring. Perpetual license provides continuous access to the software, but includes only one year of maintenance for updates and patches |
| DCP-SFT1    | Device Client Pack - 1 Year Term + Maintenance (License covers Launcher, Enterprise Browser, BasicTE, and Mobility Web SDK)  |
| DCP-SFT2    | Device Client Pack - 2 Year Term + Maintenance (License covers Launcher, Enterprise Browser, BasicTE, and Mobility Web SDK)  |
| DCP-SFT3    | Device Client Pack - 3 Year Term + Maintenance (License covers Launcher, Enterprise Browser, BasicTE, and Mobility Web SDK)  |
| DCP-SFT4    | Device Client Pack - 4 Year Term + Maintenance (License covers Launcher, Enterprise Browser, BasicTE, and Mobility Web SDK)  |
| DCP-SFT5    | Device Client Pack - 5 Year Term + Maintenance (License covers Launcher, Enterprise Browser, BasicTE, and Mobility Web SDK)  |

# CT47 SCANNING

## Scan Handle Side by Side Comparison

Use for Scan intensive applications.



|   | PART NUMBER | DESCRIPTION   |
|---|-------------|---|
| 1 | CT45-SH-UVN | CT45 and CT45 XP universal scan handle to be used with CT45/XP without Protective Boot    |
| 2 | CT47-SH-UVB | CT47 universal scan handle to be used with CT47 with Protective Boot (includes CT47-PB-1) |

# CT47 SCANNING

## Option 1 - Scan Handle

Use for Scan intensive applications, also compatible with using Rear Camera with Scan Handle installed.

This scan handle is ONLY compatible with Non-Booted charging docks.



Stylus



Side View



Rear View

| PART NUMBER | DESCRIPTION  |
|-------------|--|
| 1           | <p>CT45, CT45 XP and CT47 universal scan handle to be used with CT45/CT45 XP/ CT47 without protective boot<br/>Compatible for use with Home Base and Charge Base without removal.</p> <p>CT45-SH-UVN</p> <p>CT40-HB-0 / CT40-HB-UVN-0 Home Base CT40-CB-CNV-0 / CT40-CB-UVN-0 Quad Charge Base<br/>                     CT40-EB-0 / CT40-EB-UVN-0 Ethernet Home Base CT40-NB-CNV-0 / CT40-NB-UVN-0 Quad Net Base<br/>                     CT40-DB-0 / CT40-DB-UVN-0 Display Base</p> <p>Not Compatible with the Protective Boot Bases</p> <p>CT40-HB-UVB-0 Protective Boot Home Base<br/>                     CT40-EB-UVB-0 Protective Boot Ethernet Home Base<br/>                     CT40-DB-UVB-0 Protective Boot Display Base<br/>                     CT40-CB-PB-0 Protective Boot Quad Charge Base CT40-CB-UVB-0 Protective Boot Quad Charge Base<br/>                     CT40-NB-PB-0 Protective Boot Quad Net Base CT40-NB-UVB-0 Protective Boot Quad Net Base</p> |

# CT47 SCANNING

## Option 2 - Scan Handle with Protective Boot

Use for Scan intensive applications with additional protection of the protective boot.  
 This scan handle is ONLY compatible with Booted charging docks.



Stylus



Side View



Rear View

| PART NUMBER                                       | DESCRIPTION  |  |   |   |  |                                     |  |  |   |  |  |
|---|--|--|---|---|--|-------------------------------------|--|--|---|--|--|
| 1 CT47-SH-UVB                                     | CT47 universal scan handle to be used with CT47 with Protective Boot (includes CT47-PB-1)<br>Compatible for use with Protective Boot Home Base and Charge Base without removal.  |  |   |   |  |                                     |  |  |   |  |  |
|   | CT40-HB-UVB-0 Protective Boot Home Base  |  |   |   |  |                                     |  |  |   |  |  |
|   | CT40-EB-UVB-0 Protective Boot Ethernet Home Base   |  |   |   |  |                                     |  |  |   |  |  |
|   | CT40-DB-UVB-0 Protective Boot Display Base   |  |   |   |  |                                     |  |  |   |  |  |
|   | CT40-CB-PB-0 Protective Boot Quad Charge Base  |  |   |   |  |                                     |  |  |   |  |  |
|   | CT40-NB-PB-0 Protective Boot Quad Net Base   |  |   |   |  |                                     |  |  |   |  |  |
|   | <table border="0"> <tr> <td>CT40-CB-UVB-0 Protective Boot Quad Charge Base</td> <td>CT40-NB-UVB-0 Protective Boot Quad Net Base</td> </tr> <tr> <td colspan="2">Not Compatible with the Non-Protective Boot Bases</td> </tr> <tr> <td>CT40-HB-0 / CT40-HB-UVN-0 Home Base</td> <td>CT40-CB-CNV-0 / CT40-CB-UVN-0 Quad Charge Base</td> </tr> <tr> <td>CT40-EB-0 / CT40-EB-UVN-0 Ethernet Home Base</td> <td>CT40-NB-CNV-0 / CT40-NB-UVN-0 Quad Net Base</td> </tr> <tr> <td>CT40-DB-0 / CT40-DB-UVN-0 Display Base</td> <td></td> </tr> </table> | CT40-CB-UVB-0 Protective Boot Quad Charge Base | CT40-NB-UVB-0 Protective Boot Quad Net Base | Not Compatible with the Non-Protective Boot Bases |  | CT40-HB-0 / CT40-HB-UVN-0 Home Base | CT40-CB-CNV-0 / CT40-CB-UVN-0 Quad Charge Base | CT40-EB-0 / CT40-EB-UVN-0 Ethernet Home Base | CT40-NB-CNV-0 / CT40-NB-UVN-0 Quad Net Base | CT40-DB-0 / CT40-DB-UVN-0 Display Base |  |
| CT40-CB-UVB-0 Protective Boot Quad Charge Base    | CT40-NB-UVB-0 Protective Boot Quad Net Base  |  |   |   |  |                                     |  |  |   |  |  |
| Not Compatible with the Non-Protective Boot Bases |  |  |   |   |  |                                     |  |  |   |  |  |
| CT40-HB-0 / CT40-HB-UVN-0 Home Base               | CT40-CB-CNV-0 / CT40-CB-UVN-0 Quad Charge Base   |  |   |   |  |                                     |  |  |   |  |  |
| CT40-EB-0 / CT40-EB-UVN-0 Ethernet Home Base      | CT40-NB-CNV-0 / CT40-NB-UVN-0 Quad Net Base  |  |   |   |  |                                     |  |  |   |  |  |
| CT40-DB-0 / CT40-DB-UVN-0 Display Base            |  |  |   |   |  |                                     |  |  |   |  |  |

# CT47 PROTECTIVE BOOT

## Dockable Protective Boot

Use when protective boot is required with or without scan handle and dockable, compatible with handstrap installed.



| PART NUMBER | DESCRIPTION          |
|-------------|----------------------|
| 1 CT47-PB-1 | CT47 Protective Boot |

# CT47 DESKTOP COMMUNICATIONS

## Option 1 – Portable – Non-Booted or Booted

USB Communication to PC/ Mac OR Snap-On Charging.

CT47 Non-Booted



CT47 Booted  
CT47-PB-1



**PART NUMBER**      **DESCRIPTION**

|          |              |   |
|----------|--------------|---|
| <b>1</b> | CT45-SN-CNV  | CT45/CT45XP/CT47 Booted and Non-Booted Snap On adaptor. Provides tethered USB client connectivity. Compatible with hand strap, battery pack, and scan handle. Charges mobile computer battery in four hours or less. Kit includes snap-on adapter with convertible adaptor (CT45-SN-IST). |
| <b>2</b> | 50136024-001 | KIT,5V/2A PS,5 PLUGS PACKED, ROW Includes US,UK,AU,EU,IN adapters   |

## Option 2 – Fixed with Universal Cup

USB and optional Ethernet Communication & Single Battery Charger.

CT47 Non-Booted



CT47 Booted  
CT47-PB-1



CT40-HB-UVN-0 Home Base    CT40-EB-UVN-0 eHome Base  
CT40-HB-UVB-0 Home Base    CT40-EB-UVB-0 eHome Base



Rear View



**PART NUMBER**      **DESCRIPTION**

|           |               |  |
|-----------|---------------|--|
| <b>1A</b> | CT40-HB-UVN-0 | <b>Non-Booted</b> HomeBase - Kit includes (CT40-UCP-N), Dock & Power Supply, No Power Cord           |
| <b>OR</b> | CT40-EB-UVN-0 | <b>Non-Booted eHomeBase – Ethernet</b> Kit includes (CT40-UCP-N), Dock & Power Supply, No Power Cord |
| <b>1B</b> | CT40-HB-UVB-0 | <b>Booted</b> HomeBase - Kit includes (CT40-UCP-B), Dock & Power Supply, No Power Cord               |
| <b>OR</b> | CT40-EB-UVB-0 | <b>Booted eHomeBase – Ethernet</b> Kit includes (CT40-UCP-B), Dock & Power Supply, No Power Cord     |
| <b>2</b>  | 321-576-004   | Cable Assembly - USB Type A to Type B  |
| <b>3</b>  | **            | IEC C13 AC Power Cord – See Page 44 for Country Specific Power Cords                                 |



# CT47 COMMUNICATIONS

## Option 3 – USB Type C On-The-Go (OTG) Desktop

USB C Communication to PC/ Mac OR Charging.

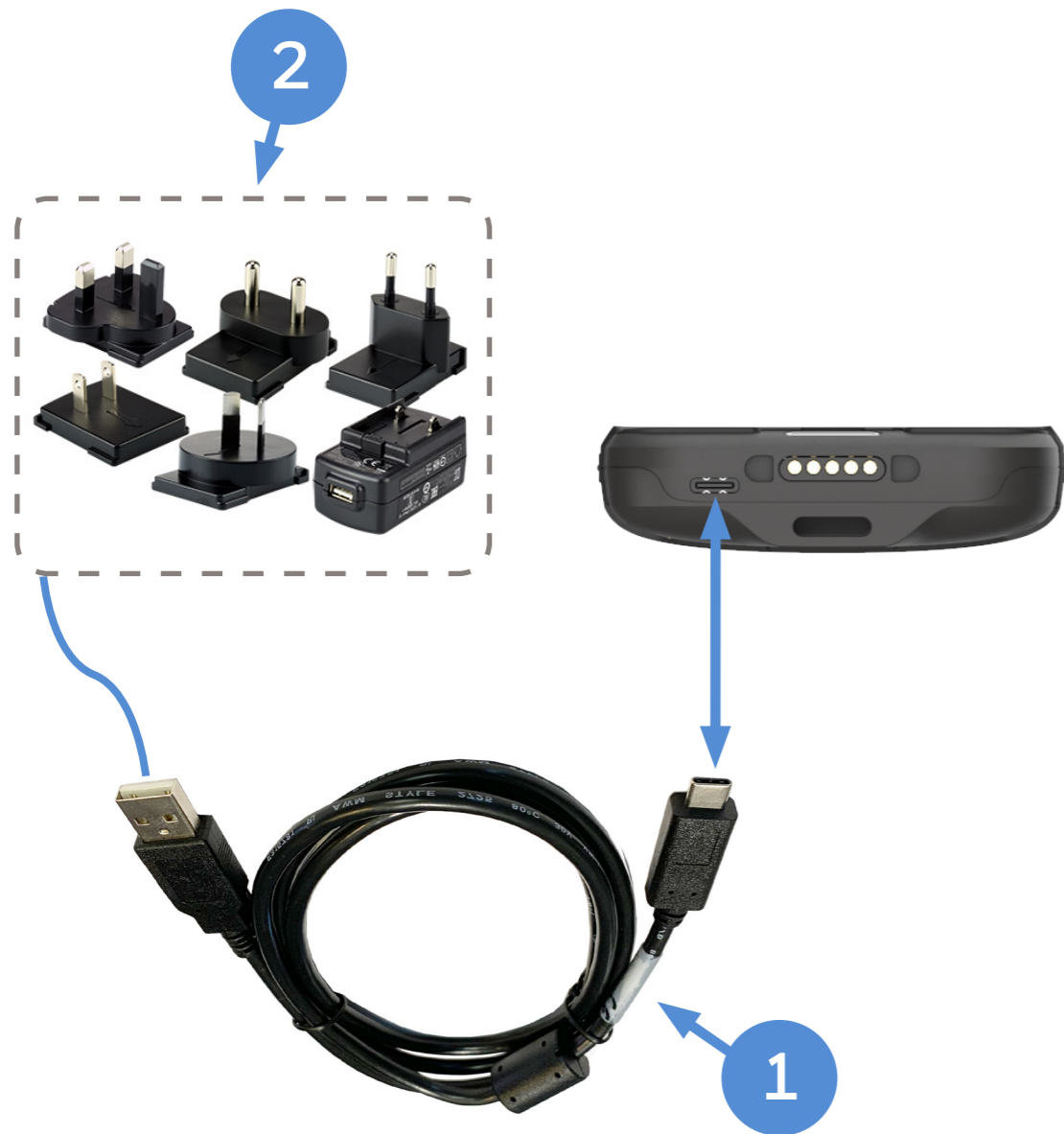

| PART NUMBER | DESCRIPTION  |
|-------------|--|
| 1           | CBL-500-120-S00-05 USB type A to type C, 1.2 m (3.9 ft)                        |
| 2           | 50136024-001 KIT,5V/2A PS,5 PLUGS PACKED, ROW Includes US,UK,AU,EU,IN adapters |

## Option 4 – USB Type C On-The-Go (OTG) Vehicle

USB C Communication to Vehicle OR Charging.



| PART NUMBER | DESCRIPTION  |
|-------------|--|
| 1A          | CBL-500-120-S00-05 USB type A to type C, 1.2 m (3.9 ft)  |
| 1B          | CT45 and CT45XP Booted and Non-Booted Snap On adaptor. Provides tethered USB client connectivity. Compatible with hand strap, battery pack, and scan handle. Charges mobile computer battery in four hours or less. Kit includes snap-on adaptor with convertible adaptor (CT45-SN-IST).                             |
| 2           | CT45-CIGR-1 Charging CT45, CT45XP, CT40 and CT40XP configurations on vehicle. Quick Charge 3.0 compliant. Requires CT45 USB adapter (CT45-SN-CNV ) or USB cable (CBL-500-120-S00-05 ) to be ordered separately. (Converts 12 V/24 V cigarette lighter port to USB type-A power adapter for snap-on use in a vehicle) |

# CT47 DESKTOP COMMUNICATIONS

## Option 5 - Display Base with Universal Cup

Connect USB peripherals (keyboard, mouse) and External Monitor via HDMI.



| PART NUMBER      | DESCRIPTION  |
|------------------|--|
| 1A CT40-DB-UVN-0 | <b>Non-Booted</b> Display Dock - Kit includes (CT40-UCP-N), Display Base & Power Supply, No Power Cord |
| 1B CT40-DB-UVB-0 | <b>Booted</b> Display Dock - Kit includes (CT40-UCP-B), Display Base & Power Supply, No Power Cord     |
| 2 **             | IEC C13 AC Power Cord – See Page 44 for Country Specific Power Cords                                   |

# CT47 VEHICLE INSTALL

## Option 1 – Portable/ Sub Contractor Install

Simple Vehicle Charging, portable between vehicles.

Compatible with CT47 with or without CT47-PB-1 Protective Boot installed.



## Option 2 – Portable/ Sub Contractor Install

Windscreen Suction Cup Mount, portable between vehicles.

Compatible with CT47 with or without CT47-PB-1 Protective Boot installed.



Recommended Screws  
8#-32-UNC  
(Length = 0.5 inch)  
50143775-001 Pack 4 Screws

**PART NUMBER DESCRIPTION**

|   |             |  |
|---|-------------|--|
| 1 | CT45-SN-CNV | CT45/CT45XP/CT47 Booted and Non-Booted Snap On adaptor. Provides tethered USB client connectivity. Compatible with hand strap, battery pack, and scan handle. Charges mobile computer battery in four hours or less. Kit includes snap-on adaptor with convertible adaptor (CT45-SN-IST).              |
| 2 | CT45-CIGR-1 | Charging CT45, CT45XP, CT40 and CT40XP configurations on vehicle. Quick Charge 3.0 compliant. Requires CT45 USB adapter (CT45-SN-CNV) or USB cable (CBL-500-120-S00-05) to be ordered separately. (Converts 12 V/24 V cigarette lighter port to USB type-A power adapter for snap-on use in a vehicle) |

**PART NUMBER DESCRIPTION**

|   |                |   |
|---|----------------|---|
| 1 | CT45-VD-CNV    | CT45/ CT45 XP/ CT47 Booted and Non-Booted Vehicle Dock. For charging CT45/XP with or without a convertible adaptor, compatible with hand strap. NFC tag integrated for seamless pairing with mobile computer. Kit includes vehicle dock (CT40-VD-CNV) with convertible adaptor (CT45-VD-IST). |
| 2 | RAM-B-166-202U | Suction Cup Mount Kit   |
| 3 | 50138169-001   | Cigarette Lighter Power Adapter Cable   |

# CT47 VEHICLE INSTALL

## Option 3 - Fixed Vehicle Install with Direct Connection to Vehicle Battery

Best used when the vehicle input voltage varies, 10- 30V.

Compatible with CT47 with or without CT47-PB-1 Protective Boot installed.

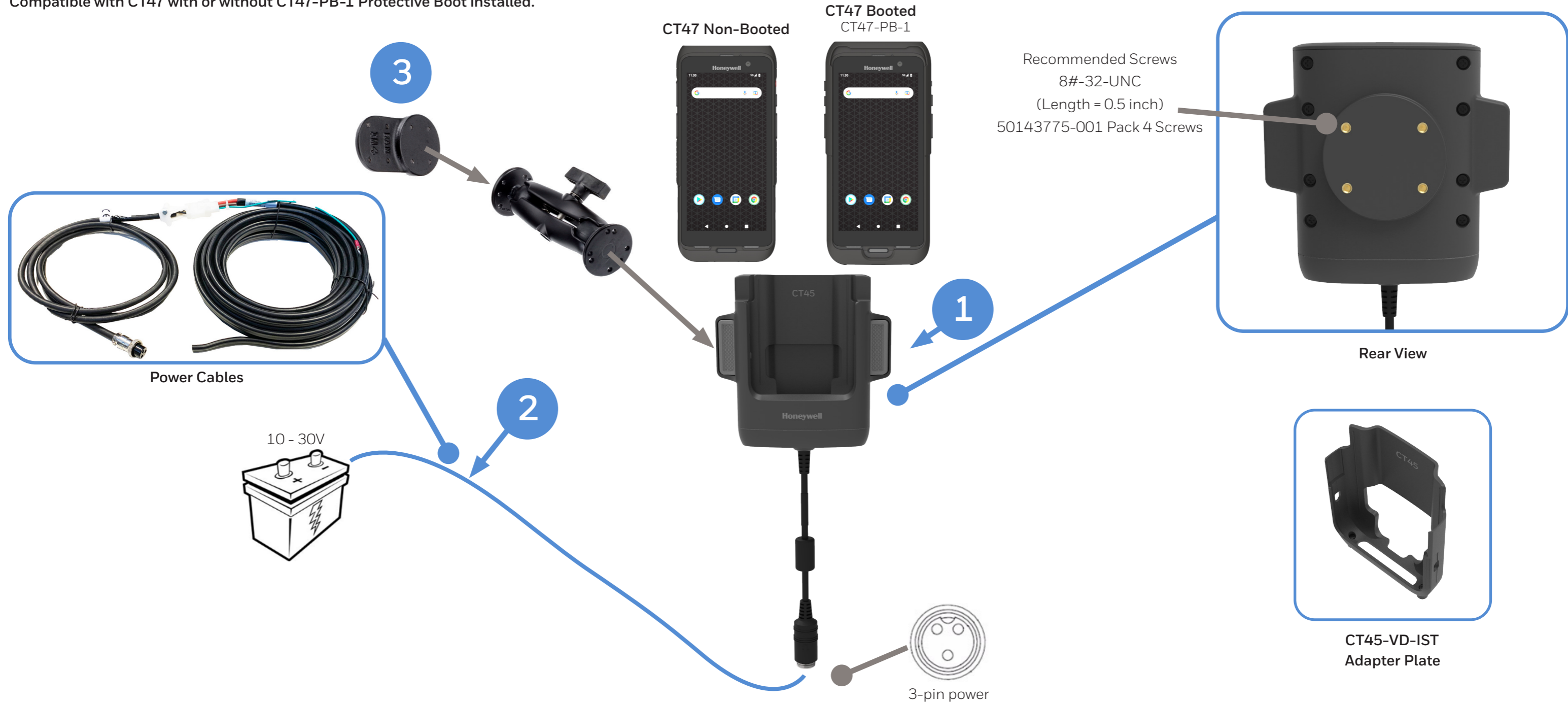

| PART NUMBER   | DESCRIPTION   |
|---------------|---|
| 1 CT45-VD-CNV | CT45/ CT45 XP/ CT47 Booted and Non-Booted Vehicle Dock. For charging CT45/XP with or without a convertible adaptor, compatible with hand strap. NFC tag integrated for seamless pairing with mobile computer. Kit includes vehicle dock (CT40-VD-CNV) with convertible adaptor (CT45-VD-IST). |
| 2 203-802-001 | Vehicle Dock Installation Kit (Power Option: For connection of Vehicle Dock directly to vehicle battery. Includes power cables and cable mounting hardware)   |
| 3 805-611-001 | Mounting Kit, V-Dock RoHS   |

# CT47 VEHICLE INSTALL

## Option 4 - Fixed Vehicle Install with Direct Connection to Vehicle Battery - External Speaker

Best used when the vehicle input voltage varies, 10- 30V.

Compatible with CT47 with or without CT47-PB-1 Protective Boot installed.



| PART NUMBER | DESCRIPTION   |
|-------------|---|
| 1           | CT45-VD-CNV-SPK CT45/ CT45 XP/ CT47 Booted and Non-Booted Vehicle Dock with External Speaker. For charging CT45/XP with or without a convertible adaptor, compatible with hand strap. NFC tag integrated for seamless pairing with mobile computer. Kit includes vehicle dock with convertible adaptor (CT45-VD-IST). |
| 2           | 203-802-001 Vehicle Dock Installation Kit (Power Option: For connection of Vehicle Dock directly to vehicle battery. Includes power cables and cable mounting hardware)   |
| 3           | 805-611-001 Mounting Kit, V-Dock RoHS   |

# CT47 VEHICLE INSTALL

## Option 5 - Fixed Vehicle Install with Direct Connection to Vehicle Battery/ Fuse Block

Best used when the vehicle input voltage varies, 10- 30V.

Compatible with CT47 with or without CT47-PB-1 Protective Boot installed.



|                 | PART NUMBER | DESCRIPTION   |
|-----------------|-------------|---|
| <b>1</b>        | CT45-VD-CNV | CT45/ CT45 XP/ CT47 Booted and Non-Booted Vehicle Dock. For charging CT45/XP with or without a convertible adaptor, compatible with hand strap. NFC tag integrated for seamless pairing with mobile computer. Kit includes vehicle dock (CT40-VD-CNV) with convertible adaptor (CT45-VD-IST). |
| <b>2</b>        | 226-109-003 | 72" (182.88 cm) Fuse block Power Cable with spade lugs and 3-pin connector  |
| <b>OR</b>       | 226-109-004 | 22" (55.8 cm) Fuse block Power Cable with spade lugs and 3-pin connector  |
| <b>3</b>        | 805-611-001 | Mounting Kit, V-Dock RoHS   |
| <b>OPTIONAL</b> | 203-803-001 | Vehicle Dock Fuse Block Power Kit RoHS (Provides connection to vehicle fuse block). Requires Power Cable (226-109-003 or 226-109-004).  |

# CT47 VEHICLE INSTALL

## Option 6 - Fixed Vehicle Install with Direct Connection to Vehicle Battery/ Fuse Block - External Speaker

Best used when the vehicle input voltage varies, 10- 30V.

Compatible with CT47 with or without CT47-PB-1 Protective Boot installed.

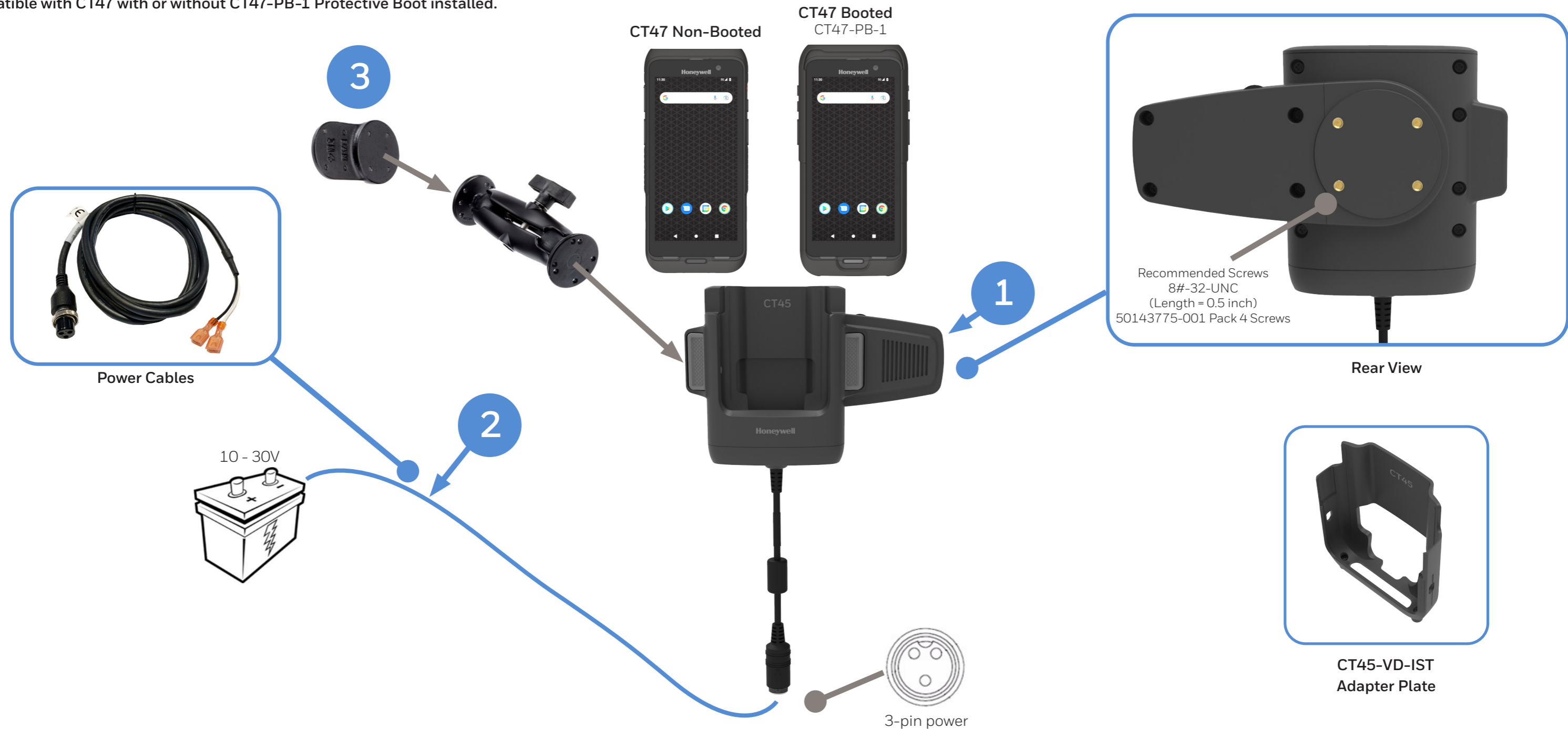

|          | PART NUMBER     | DESCRIPTION   |
|----------|-----------------|---|
| 1        | CT45-VD-CNV-SPK | CT45/ CT45 XP/ CT47 Booted and Non-Booted Vehicle Dock with External Speaker. For charging CT45/XP with or without a convertible adaptor, compatible with hand strap. NFC tag integrated for seamless pairing with mobile computer. Kit includes vehicle dock with convertible adaptor (CT45-VD-IST). |
| 2        | 226-109-003     | 72" (182.88 cm) Fuse block Power Cable with spade lugs and 3-pin connector  |
| OR       | 226-109-004     | 22" (55.8 cm) Fuse block Power Cable with spade lugs and 3-pin connector  |
| 3        | 805-611-001     | Mounting Kit, V-Dock RoHS   |
| OPTIONAL | 203-803-001     | Vehicle Dock Fuse Block Power Kit RoHS (Provides connection to vehicle fuse block). Requires Power Cable (226-109-003 or 226-109-004).  |

# CT47 VEHICLE INSTALL

## Option 7 - Fixed Vehicle Install with Thor DC/DC Converter

Best used when the vehicle input voltage varies, 9-60V or 50-150V.  
 Compatible with CT47 with or without CT47-PB-1 Protective Boot installed.

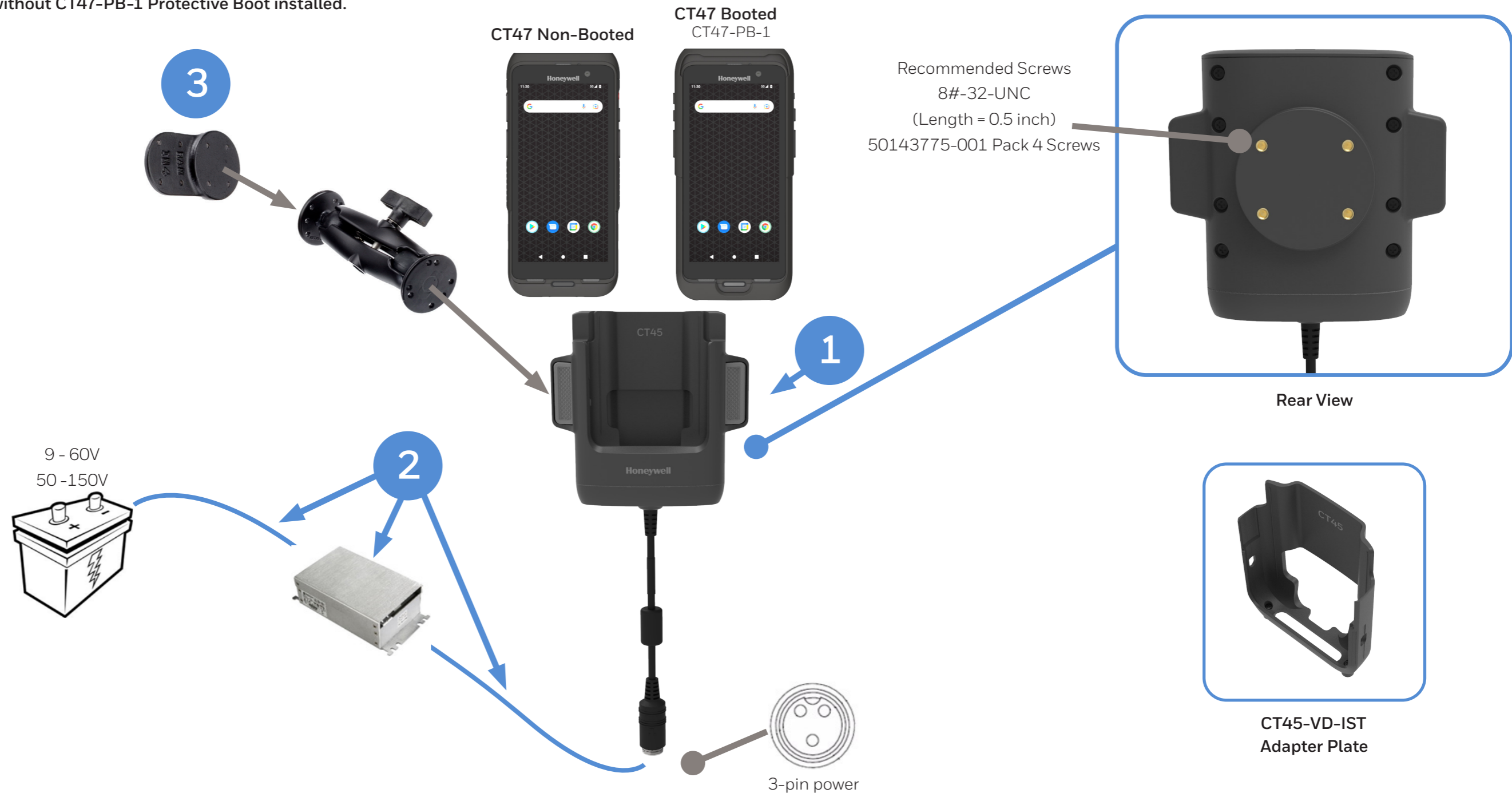

| PART NUMBER | DESCRIPTION   |
|-------------|---|
| 1           | CT45-VD-CNV CT45/ CT45 XP/ CT47 Booted and Non-Booted Vehicle Dock. For charging CT45/XP with or without a convertible adaptor, compatible with hand strap. NFC tag integrated for seamless pairing with mobile computer. Kit includes vehicle dock (CT40-VD-CNV) with convertible adaptor (CT45-VD-IST). |
| 2           | 9000311PWRSPLY DC/DC Converter Kit, 9-60V DC, RoHS (Requires 226-109-003 Wiring Harness)  |
| OR          | 9000313PWRSPLY DC/DC Converter Kit, 50-150V DC RoHS (Requires 226-109-003 Wiring Harness)   |
|             | 226-109-003 72" (182.88 cm) Fuse block Power Cable with spade lugs and 3-pin connector  |
| 3           | 805-611-001 Mounting Kit, V-Dock RoHS   |



# CT47 VEHICLE INSTALL

## Option 8 - Fixed Vehicle Install with Thor DC/DC Converter - External Speaker

Best used when the vehicle input voltage varies, 9-60V or 50-150V.  
 Compatible with CT47 with or without CT47-PB-1 Protective Boot installed.



| PART NUMBER              | DESCRIPTION   |
|--------------------------|---|
| <b>1</b> CT45-VD-CNV-SPK | CT45/ CT45 XP/ CT47 Booted and Non-Booted Vehicle Dock with External Speaker. For charging CT45/XP with or without a convertible adaptor, compatible with hand strap. NFC tag integrated for seamless pairing with mobile computer. Kit includes vehicle dock with convertible adaptor (CT45-VD-IST). |
| <b>2</b> 9000311PWRSPLY  | DC/DC Converter Kit, 9-60V DC, RoHS (Requires 226-109-003 Wiring Harness)   |
| <b>OR</b> 9000313PWRSPLY | DC/DC Converter Kit, 50-150V DC RoHS (Requires 226-109-003 Wiring Harness)  |
| 226-109-003              | 72" (182.88 cm) Fuse block Power Cable with spade lugs and 3-pin connector  |
| <b>3</b> 805-611-001     | Mounting Kit, V-Dock RoHS   |

# CT47 VEHICLE INSTALL

## CT45/ CT47 Vehicle Dock (CT45-VD-CNV) Detail View - Non-Booted



Insert  
CT45-VD-IST



Angle View  
Connector Detail



Angle View  
CT4X Non-Booted

Front View

Rear View

# CT47 VEHICLE INSTALL

## CT45/ CT47 Vehicle Dock (CT45-VD-CNV) Detail View - Booted



Front View



Rear View



Protective Boot  
CT47-PB-1



Angle View  
Connector Detail



Angle View  
CT4X Booted

# CT47 VEHICLE INSTALL

## CT45/ CT47 Vehicle Dock with External Speaker (CT45-VD-CNV-SPK) Detail View - Non-Booted

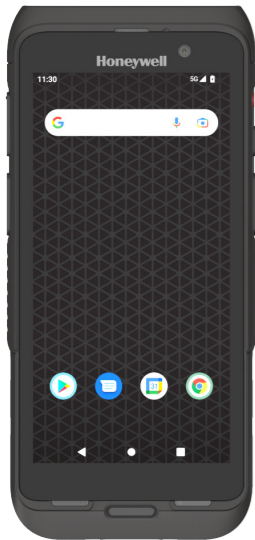

Front View



Rear View



Insert  
CT45-VD-IST



Angle View  
Connector Detail



Angle View  
CT4X Non-Booted

# CT47 VEHICLE INSTALL

## CT45/ CT47 Vehicle Dock with External Speaker (CT45-VD-CNV-SPK) Detail View – Booted



Protective Boot  
CT47-PB-1

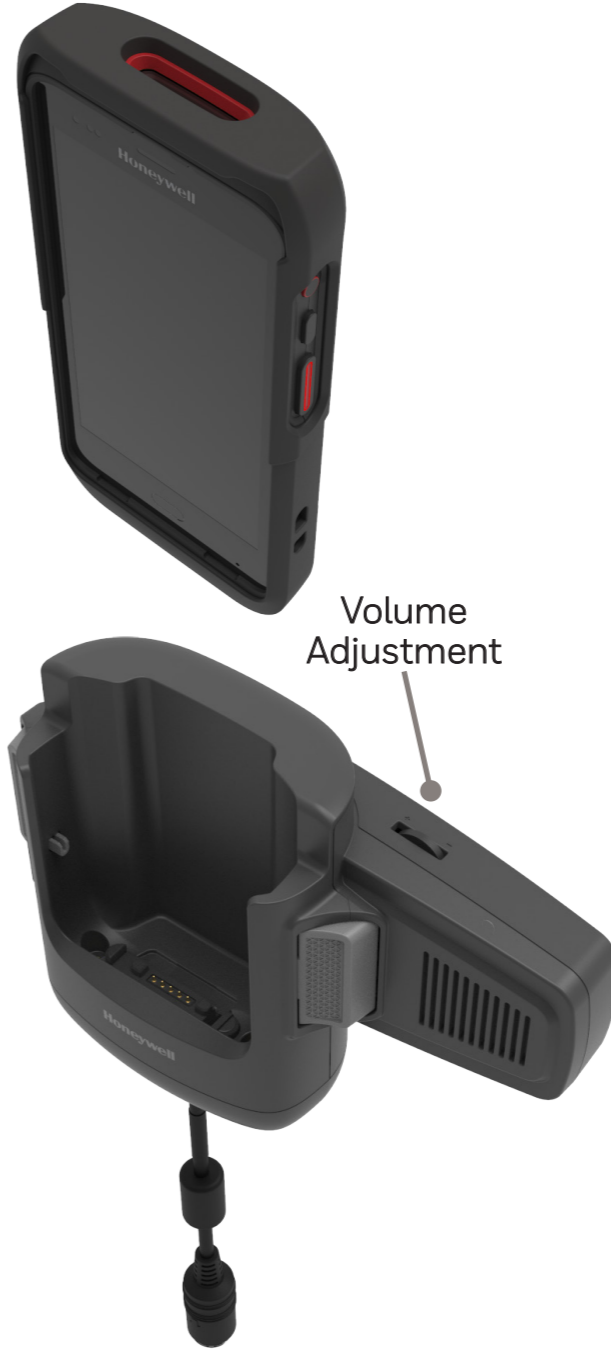

Volume  
Adjustment

Angle View  
Connector Detail



Angle View  
CT4X Booted

Front View

Rear View

# CT47 CHARGING AND COMMUNICATION

## Option 1 - Non-Booted Quad Charger with Universal Cup

Chargebase – Quad Dock Charge Only  
 Netbase – Quad Dock with Ethernet  
 Not Compatible with CT47-PB-1 Protective Boot



Kit Includes:  
 4 x CT40-UCP-N  
 CT40 / CT45 / CT47 Cup for Non-Booted

## Option 2 - Booted Quad Charger with Universal Cup

Chargebase – Quad Dock Charge Only  
 Netbase – Quad Dock with Ethernet  
 Compatible with CT47-PB-1 Protective Boot



Kit Includes:  
 4 x CT40-UCP-B  
 CT40 / CT45 / CT47 Cup for Booted

**PART NUMBER      DESCRIPTION**

|           |               |  |
|-----------|---------------|--|
| <b>1</b>  | CT40-CB-UVN-0 | <b>Non-Booted</b> Chargebase - Kit includes Dock and Power Supply                  |
| <b>OR</b> | CT40-NB-UVN-0 | <b>Non-Booted</b> Netbase - For Ethernet comms, Kit includes Dock and Power Supply |
| <b>2</b>  | **            | IEC C13 AC Power Cord – See Page 44 for Country Specific Power Cords               |

**PART NUMBER      DESCRIPTION**

|           |               |  |
|-----------|---------------|--|
| <b>1</b>  | CT40-CB-UVB-0 | <b>Booted</b> Chargebase - Kit includes Dock and Power Supply                  |
| <b>OR</b> | CT40-NB-UVB-0 | <b>Booted</b> Netbase - For Ethernet comms, Kit includes Dock and Power Supply |
| <b>2</b>  | **            | IEC C13 AC Power Cord – See Page 44 for Country Specific Power Cords           |

# CT47 CHARGING AND COMMUNICATION

## Option 3 - Non-Booted 5-Bay Charger with Battery Cup

Chargebase – Quad Dock Charge Only (4 terminals) and Quad Battery Charger (4 Batteries)

Not Compatible with CT47-PB-1 Protective Boot

Compatible with Scan Handle



Top View with Scan Handle installed



Kit Includes:  
4 x CT40-UCP-N  
CT40 / CT45 / CT47 Cup for Non-Booted

## Option 4 - Booted 5-Bay Charger with Battery Cup

Chargebase – Quad Dock Charge Only (4 terminals) and Quad Battery Charger (4 Batteries)

Compatible with CT47-PB-1 Protective Boot

Compatible with Scan Handle



Top View with Scan Handle installed



Kit Includes:  
4 x CT40-UCP-B  
CT40 / CT45 / CT47 Cup for Booted

| PART NUMBER | DESCRIPTION   |
|-------------|---|
| 1           | CT45 <b>Non-Booted</b> 5 bay Universal Dock, charge up to 4 pieces of CT45/CT40/CT45XP/CT40XP/CT47 and 4 pieces of CT4x batteries. Kit includes 5 bay Universal Dock and Power Adaptor. IEC C5 Power cord must be ordered separately. |
| 2           | ** IEC C5 AC Power Cord – See Page 44 for Country Specific Power Cords  |

| PART NUMBER | DESCRIPTION   |
|-------------|---|
| 1           | CT45 <b>Booted</b> 5 bay Universal Dock, charge up to 4 pieces of CT45/CT40/CT45XP/CT40XP/CT47 and 4 pieces of CT4x batteries. Kit includes 5 bay Universal Dock and Power Adaptor. IEC C5 Power cord must be ordered separately. |
| 2           | ** IEC C5 AC Power Cord – See Page 44 for Country Specific Power Cords  |

# CT47 CHARGING AND COMMUNICATION

## Option 5 - Non-Booted 5-Bay Charger with Universal Cups

Chargebase – 5-Bay Dock Charge Only (5 terminals)  
 Not Compatible with CT47-PB-1 Protective Boot  
 Compatible with Scan Handle



Top View with Scan Handle installed



Kit Includes:  
 4 x CT40-UCP-N  
 CT40 / CT45 / CT47 Cup for Non-Booted

## Option 6 - Booted 5-Bay Charger with Universal Cups

Chargebase – 5-Bay Dock Charge Only (5 terminals)  
 Compatible with CT47-PB-1 Protective Boot  
 Compatible with Scan Handle



Top View with Scan Handle installed



Kit Includes:  
 4 x CT40-UCP-B  
 CT40 / CT45 / CT47 Cup for Booted

**PART NUMBER DESCRIPTION**

|          |                |   |
|----------|----------------|---|
| <b>1</b> | CT45-5CB-UVN-0 | CT45 <b>Non-Booted</b> 5 bay Universal Dock, charge up to 5 pieces of CT45/CT40/CT45XP/CT40XP or CT47. Kit includes 5 bay Universal Dock and Power Adaptor. IEC C5 Power cord must be ordered separately. |
| <b>2</b> | **             | IEC C5 AC Power Cord – See Page 44 for Country Specific Power Cords   |

**PART NUMBER DESCRIPTION**

|          |                |  |
|----------|----------------|--|
| <b>1</b> | CT45-5CB-UVB-0 | CT45 <b>Booted</b> 5 bay Universal Dock, charge up to 5 pieces of CT45/CT40/CT45XP/CT40XP or CT47.. Kit includes 5 bay Universal Dock and Power Adaptor. IEC C5 Power cord must be ordered separately. |
| <b>2</b> | **             | IEC C5 AC Power Cord – See Page 44 for Country Specific Power Cords  |



# CT47 CHARGING AND COMMUNICATION

## Option 7 - Quad Battery Charger

Charge up to 4 batteries simultaneously

- Supports Batteries:
- 318-055-010 - Battery, Standard, CT40 Gen 1 (4090mAh)
  - 318-055-011 - Battery, Standard, CT40 Gen 1 (4040mAh)
  - 318-055-014 - Battery, Standard, CT40 Gen 2 (4090mAh)
  - 318-055-015 - Battery, Standard, CT40 Gen 2 (4020mAh)
  - 318-055-017 - Battery, Standard, CT40 Healthcare (4020mAh)
  - 318-055-067 - Battery, Standard, CT40 Gen 2 / XP, CT45 / XP (4020mAh)
  - 318-055-D67 - Battery, Standard, CT40 DRH / XP (4020mAh)
  - 318-055-H67 - Battery, Standard, CT40 Healthcare / XP (4020mAh)
  - CT4X-BTSC-001 - Battery, Standard, CT45 / CT47, 4775mAh
  - CT4X-BTWC-001 - Battery, Wireless, CT45 / CT47, 4680mAh
  - CT4X-BTSC-002 - Battery, NI / ATEX / IEC Ex, CT47, 4775mAh

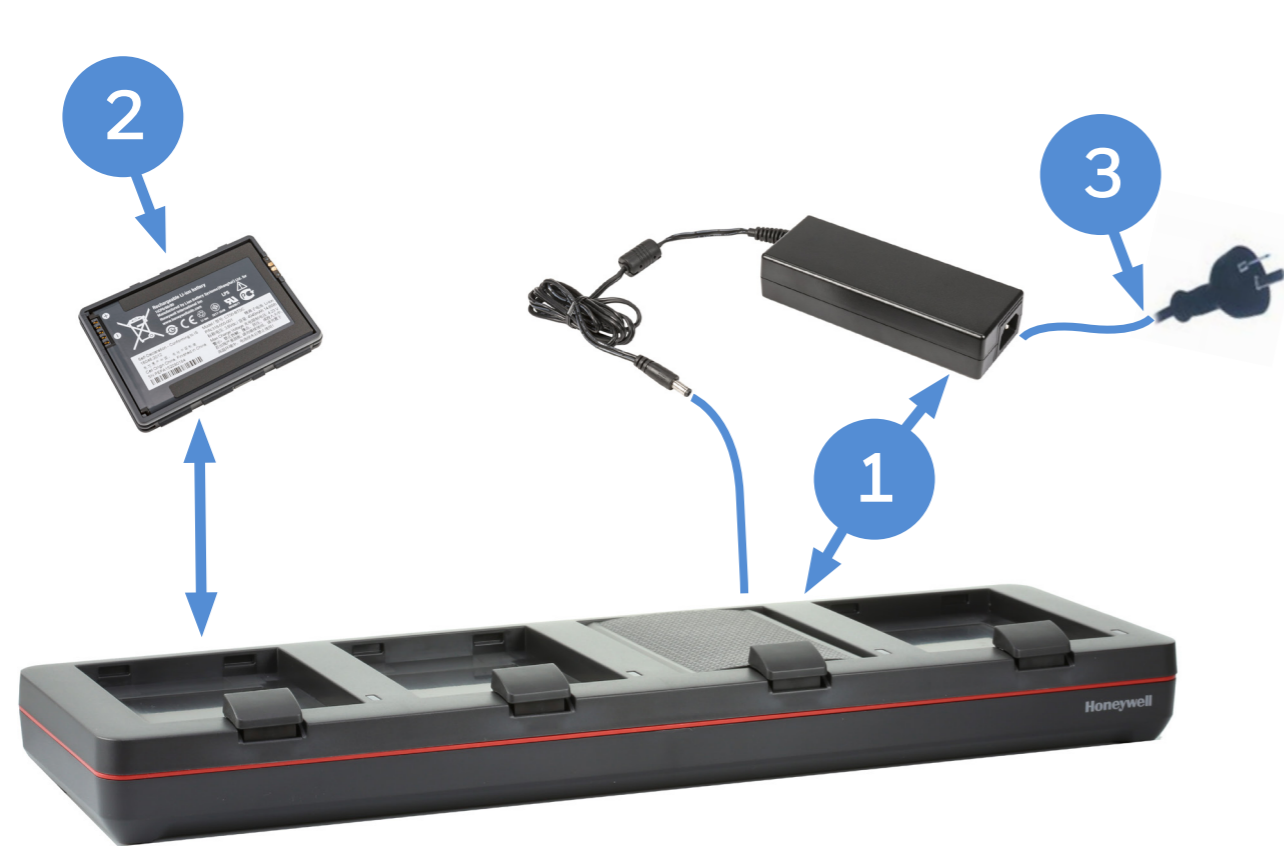

Batteries not included.

|   | PART NUMBER | DESCRIPTION  |
|---|-------------|--|
| 1 | CT40-QBC-0  | Quad Battery Charger - Kit includes Dock and Power Supply            |
| 2 | **          | Spare Battery - See Page 34 for Battery Selection                    |
| 3 | **          | IEC C13 AC Power Cord - See Page 44 for Country Specific Power Cords |

## Option 8 - 1-Bay Quad Battery Charger with Universal Cup

Charge up to 4 batteries simultaneously

- Supports Batteries:
- 318-055-010 - Battery, Standard, CT40 Gen 1 (4090mAh)
  - 318-055-011 - Battery, Standard, CT40 Gen 1 (4040mAh)
  - 318-055-014 - Battery, Standard, CT40 Gen 2 (4090mAh)
  - 318-055-015 - Battery, Standard, CT40 Gen 2 (4020mAh)
  - 318-055-017 - Battery, Standard, CT40 Healthcare (4020mAh)
  - 318-055-067 - Battery, Standard, CT40 Gen 2 / XP, CT45 / XP (4020mAh)
  - 318-055-D67 - Battery, Standard, CT40 DRH / XP (4020mAh)
  - 318-055-H67 - Battery, Standard, CT40 Healthcare / XP (4020mAh)
  - CT4X-BTSC-001 - Battery, Standard, CT45 / CT47, 4775mAh
  - CT4X-BTWC-001 - Battery, Wireless, CT45 / CT47, 4680mAh
  - CT4X-BTSC-002 - Battery, NI / ATEX / IEC Ex, CT47, 4775mAh

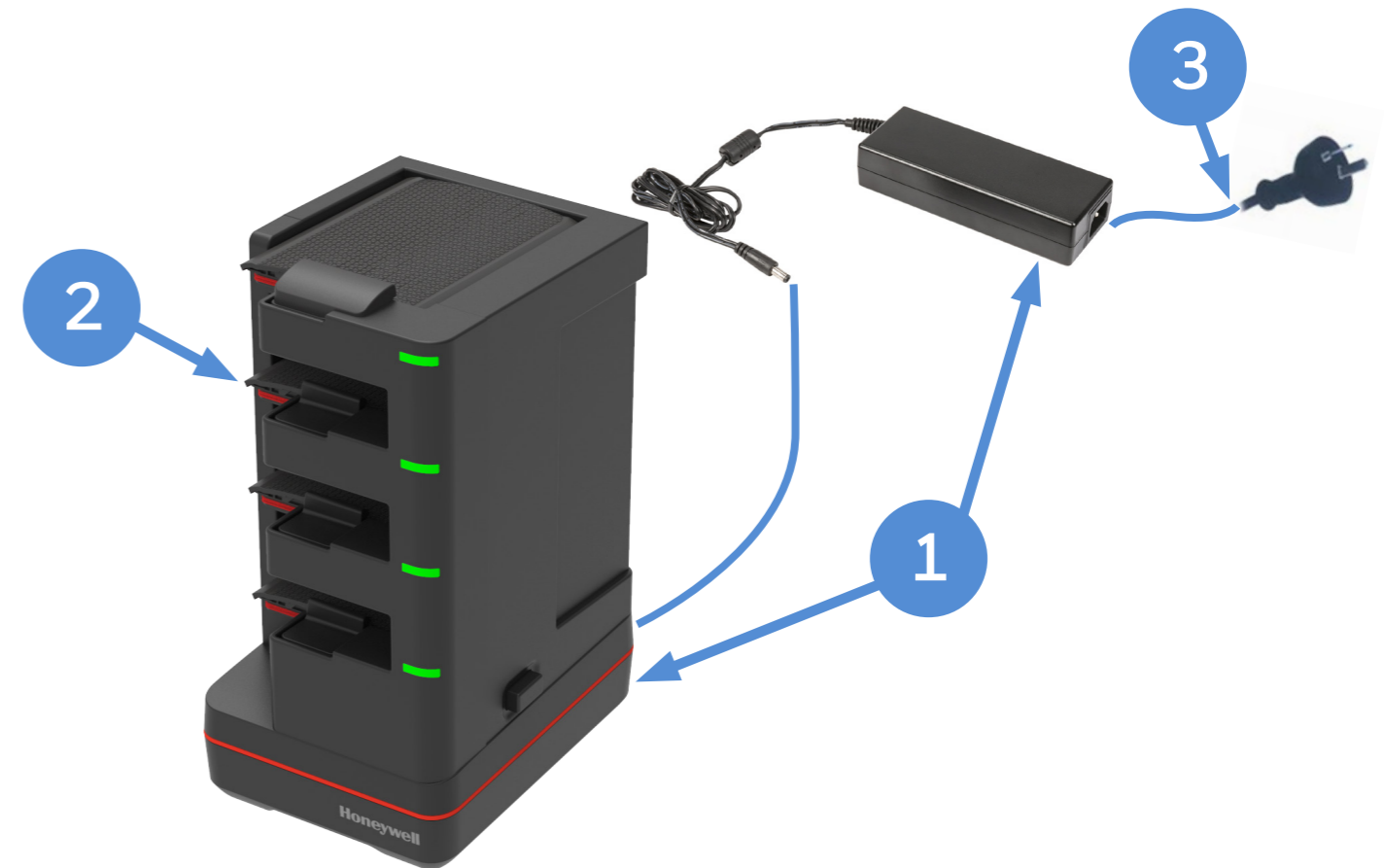

Batteries not included.

|   | PART NUMBER     | DESCRIPTION  |
|---|-----------------|--|
| 1 | CT4X-QBC-1BAY-0 | 1-Bay Quad Battery Charger - Kit includes Dock and Power Supply      |
| 2 | **              | Spare Battery - See Page 34 for Battery Selection                    |
| 3 | **              | IEC C13 AC Power Cord - See Page 44 for Country Specific Power Cords |

# CT47 CHARGING AND COMMUNICATION

## Rack / Wall Mount Bracket

The Rack/Wall Mount Bracket has been optimized to work on a standard 19-inch (48cm) rack, as well as mounting directly onto a wall. Compatible with all 4-bay chargers.

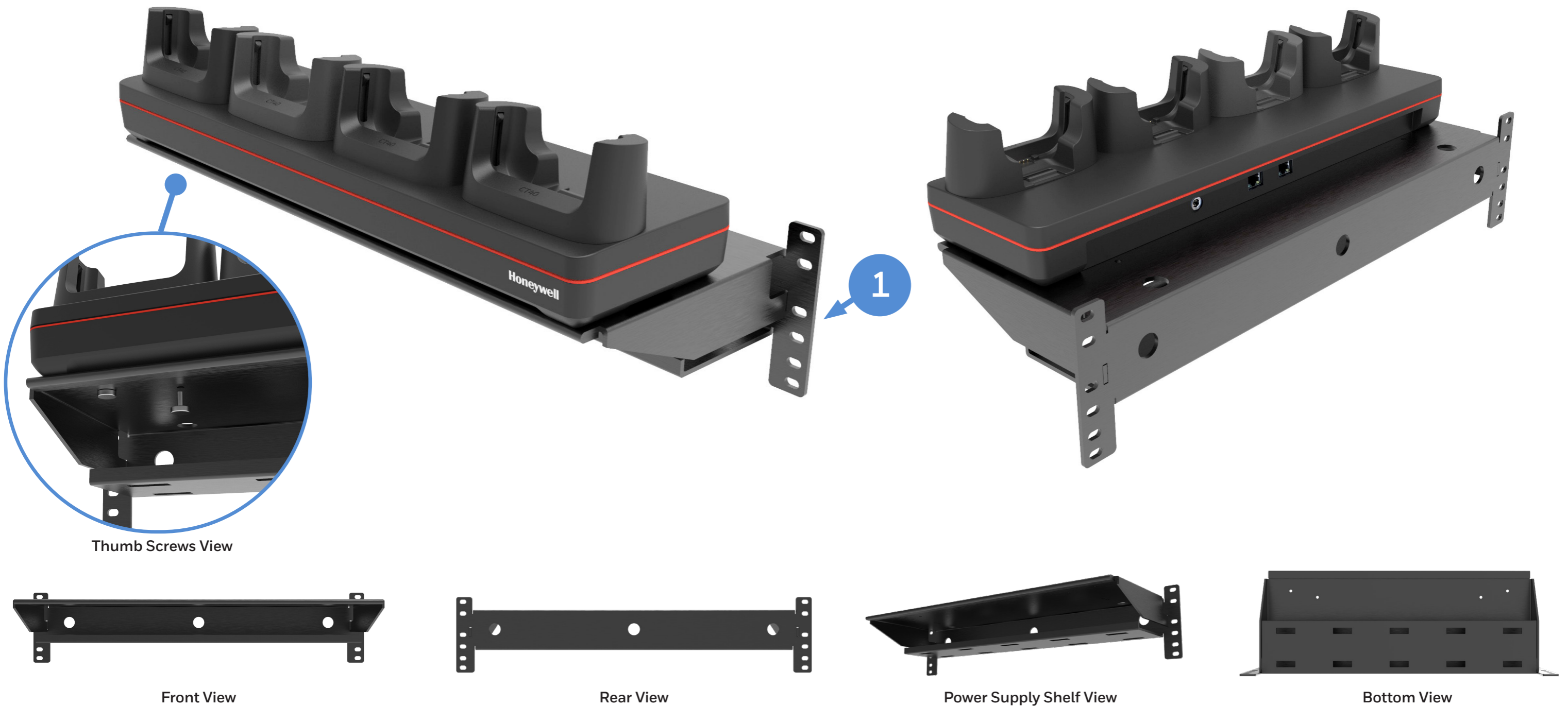

|   | PART NUMBER | DESCRIPTION  |
|---|-------------|--|
| 1 | CB-BK-01    | 4 Bay Charger Bracket, Rack / Wall Mount (includes 4 x 50180100-001 Thumb Screws M3.5x10 to securely attach the 4-bay dock to the bracket) |

# CT47 BATTERY

## Spare Battery Options



**CT47**  
CT47-xxx-xxxxx0x

**CT47 Wireless Battery**  
CT47-xxx-xxxxx0x

**CT47 NI / ATEX / IEC Ex**  
CT47-xxx-xxxxx1x

|   | PART NUMBER   | DESCRIPTION                                   |
|---|---------------|---|
| 1 | CT4X-BTSC-001 | CT45 / CT47 Standard Battery Pack, 4775mAh    |
| 2 | CT4X-BTWC-001 | CT45 / CT47 Wireless Battery Pack, 4680mAh    |
| 3 | CT4X-BTSC-002 | CT47 NI / ATEX / IEC Ex Battery Pack, 4775mAh |

# CT47 RFID

## IH40 RFID Reader with CT47 Non-Booted

Connect the IH40 to the CT47 via Bluetooth or USB.  
IH40 has a user accessible replaceable battery.



IH40 Front View



IH40 Rear View



IH40 Top View

|           | PART NUMBER      | REGION    | DESCRIPTION  |
|-----------|------------------|-----------|--|
| <b>1</b>  | IH40-1-N003S02UK | FCC / ANZ | IH40 High-Performance UHF RFID tag reader, US Frequency Range of RFID output (902-928MHz), Includes Battery  |
| <b>OR</b> | IH40-1-N003S02OK | ETSI      | IH40 High-Performance UHF RFID tag reader, EU Frequency Range of RFID output (865-868 MHz), Includes Battery |
| <b>2</b>  | IH40-BK-47       |           | CT47 Non-Booted RFID bracket for IH40 and IH25, hand strap compatible  |
| <b>3</b>  | 50155100-001     |           | IH25 Wrist Strap   |

### Honeywell Repair Services

SVCIH40-SG3N

IH40, Edge Service, Gold Maintenance Contract, 3 Year, New Contract

# CT47 RFID

## IH40 RFID Reader with CT47 Booted

Connect the IH40 to the CT47 via Bluetooth or USB.  
IH40 has a user accessible replaceable battery.



IH40 Front View



IH40 Rear View



IH40 Top View

|    | PART NUMBER      | REGION    | DESCRIPTION  |
|----|------------------|-----------|--|
| 1  | IH40-1-N003S02UK | FCC / ANZ | IH40 High-Performance UHF RFID tag reader, US Frequency Range of RFID output (902-928MHz), Includes Battery  |
| OR | IH40-1-N003S02OK | ETSI      | IH40 High-Performance UHF RFID tag reader, EU Frequency Range of RFID output (865-868 MHz), Includes Battery |
| 2  | IH40-BK-47PB     |           | CT47 Booted RFID bracket for IH40 and IH25, hand strap compatible  |
| 3  | CT47-PB-1        |           | CT47 Hard Protective Boot  |
| 4  | 50155100-001     |           | IH25 Wrist Strap   |

### Honeywell Repair Services

SVCIH40-SG3N

IH40, Edge Service, Gold Maintenance Contract, 3 Year, New Contract

# CT47 RFID CHARGING

## Option 1 - IH40 Non-Booted Quad Charger

IH40 shares the same chargers as CT40/ CT45/ CT47.



Kit Includes:  
4 x CT40-UCP-N  
CT40 / CT45/ CT47 Cup for Non-Booted

## Option 2 - IH40 Booted Quad Charger

IH40 shares the same chargers as CT40/ CT45/ CT47.

When using CT40 Booted chargers, the adapter sleeve is required to fit the IH40.

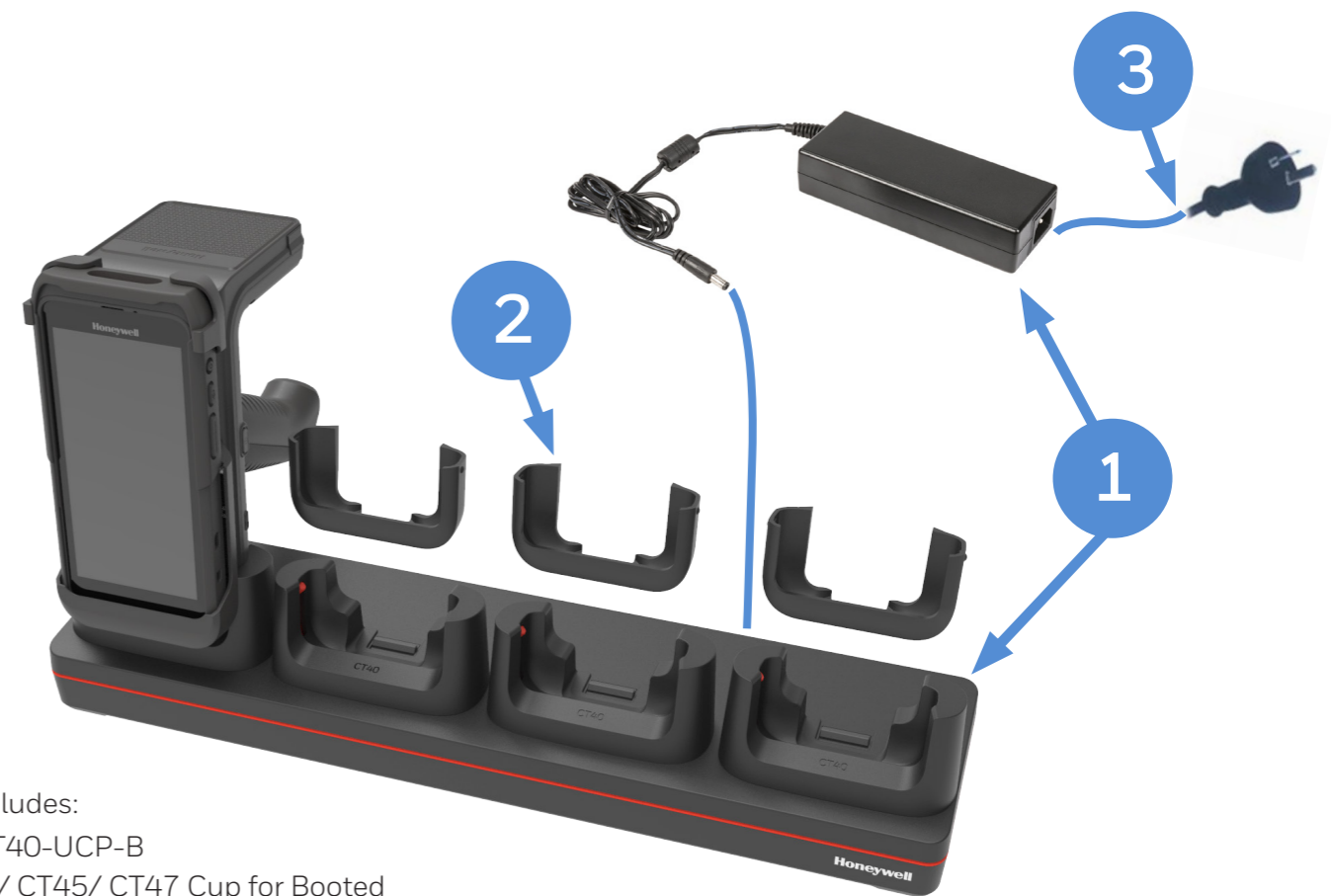

Kit Includes:  
4 x CT40-UCP-B  
CT40 / CT45/ CT47 Cup for Booted

|    | PART NUMBER   | DESCRIPTION  |
|----|---------------|--|
| 1  | CT40-CB-UVN-0 | <b>Non-Booted</b> Chargebase - Kit includes Dock and Power Supply                  |
| OR | CT40-NB-UVN-0 | <b>Non-Booted</b> Netbase - For Ethernet comms, Kit includes Dock and Power Supply |
| 2  | **            | IEC C13 AC Power Cord – See Page 44 for Country Specific Power Cords               |

|    | PART NUMBER   | DESCRIPTION  |
|----|---------------|--|
| 1  | CT40-CB-UVB-0 | <b>Booted</b> Chargebase - Kit includes Dock and Power Supply                                  |
| OR | CT40-NB-UVB-0 | <b>Booted</b> Netbase - For Ethernet comms, Kit includes Dock and Power Supply                 |
| 2  | IH40-ADP-SLV  | IH40 Adapter Sleeve for <b>Booted</b> CT40 cup (CT40-UCP-B) - Order 4 adapters per Charge Base |
| 3  | **            | IEC C13 AC Power Cord – See Page 44 for Country Specific Power Cords                           |

# CT47 RFID

## Option 3 - IH40 Quad Battery Charger

IH40 shares the same chargers as EDA50/ EDA51 battery charger.

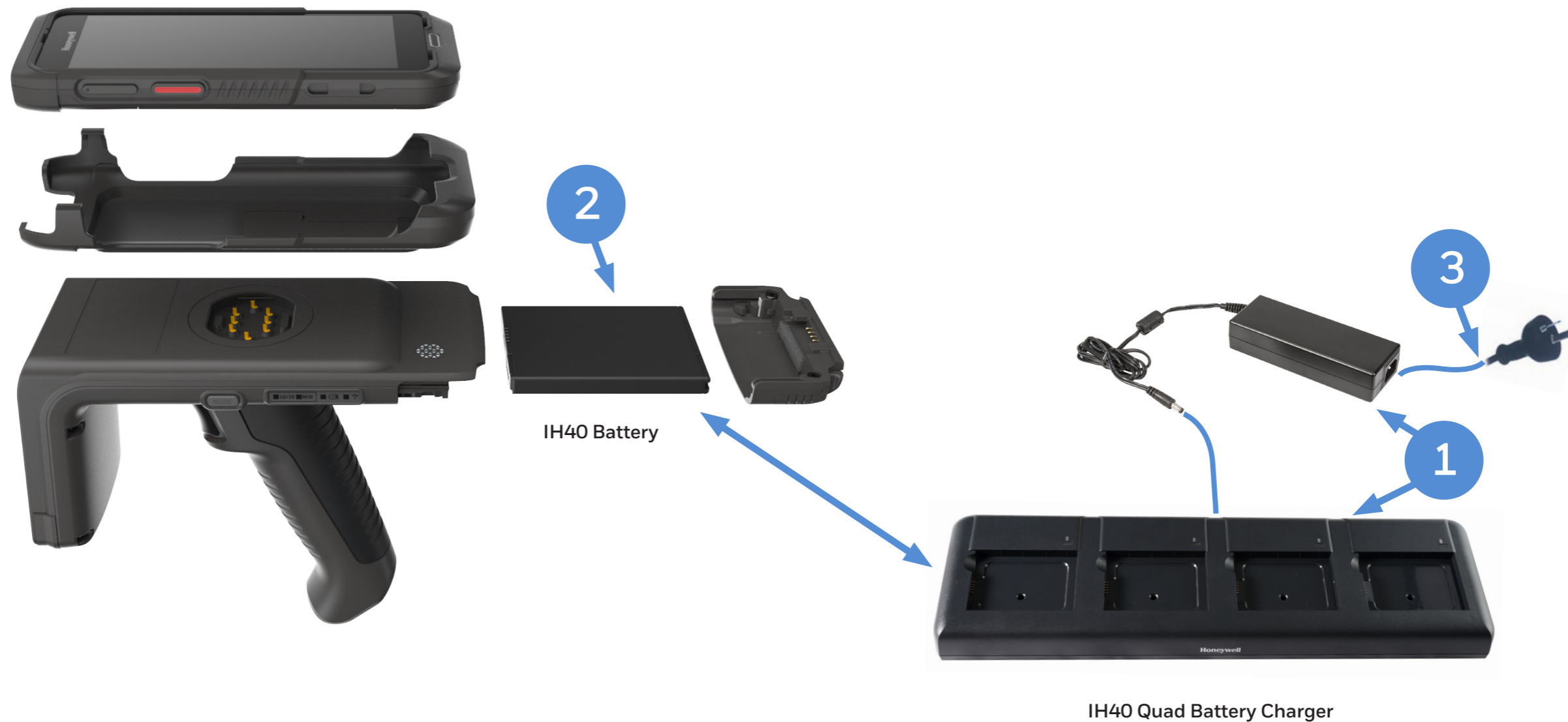

| PART NUMBER | DESCRIPTION   |
|-------------|---|
| 1           | EDA50-QBC-0 Kit IH25/IH40/EDA50/EDA70/EDA71 Quad Battery Charger. Kit includes Dock, Power Supply, No Power Cord. |
| 2           | 50129589-001 Accessory, Battery (3.8V, 4,000mAh), EDA50/51/70/71  |
| 3           | ** IEC C13 AC Power Cord – See Page 44 for Country Specific Power Cords   |

# CT47 HEADSET

## USB-C CT47 Push To Talk (PTT) Headset

USB-C audio PTT and VoIP ready to support In-Store Communication with leading 3rd party applications.  
Compatible with CT47-PB-1 Boot installed.



| PART NUMBER     | DESCRIPTION             |
|-----------------|-------------------------|
| 1 MBL-HDST-USBC | Headset with PTT, USB C |



# MISCELLANEOUS

## Optional Parts



| PART NUMBER | DESCRIPTION                |
|-------------|----------------------------|
| CT47-HS-3PK | CT47 HAND STRAP, pack of 3 |



Note: Stylus is not to be used with screen protector

| PART NUMBER    | DESCRIPTION   |
|----------------|---|
| 213-048-001    | Pack of 5 CT40 / CT50 / CT60 replacement styluses.  |
| 8754-871600-20 | Pack of 10 CT40 / CT50 / CT60 replacement styluses. |

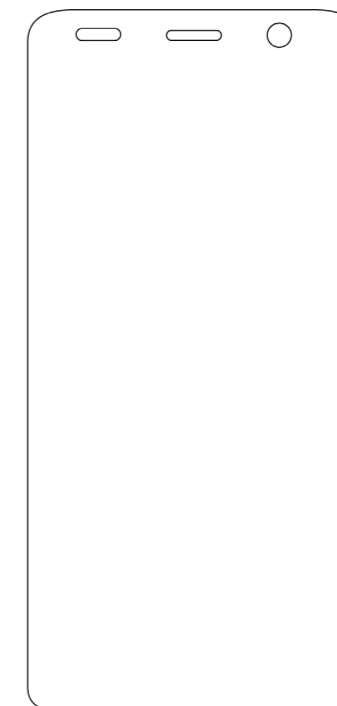

| PART NUMBER | DESCRIPTION                   |
|-------------|-------------------------------|
| CT47-SP-1PK | CT47 Screen Protector, 1 Pack |

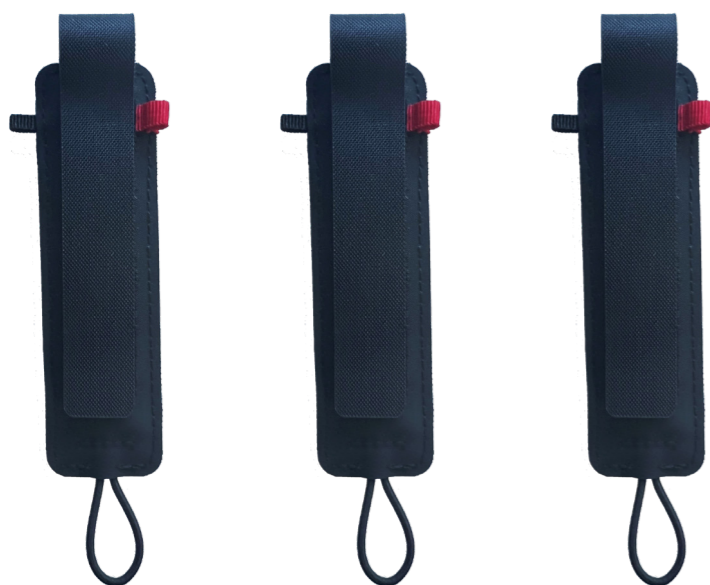

| PART NUMBER | DESCRIPTION   |
|-------------|---|
| CT45-HS-FM  | CT45 HAND STRAP for Field Mobility 3 pieces per pack. Larger handstrap for field mobility workers with big hands or those who wear gloves. Compatible with Vehicle Docks. |



| PART NUMBER   | DESCRIPTION  |
|---------------|--|
| CT40-STL-1PKC | CT40 and CT45 Stylus for use with or without screen protectors. Pack of 1. |



| PART NUMBER | DESCRIPTION                                       |
|-------------|---|
| 825-239-001 | HOLSTER,SCAN HANDLE, CT4X, CT50, CT60 and CT60 XP |

# MISCELLANEOUS

## Optional Parts

Replacement Power Supplies.



IEC C14



IEC C14



IEC C6

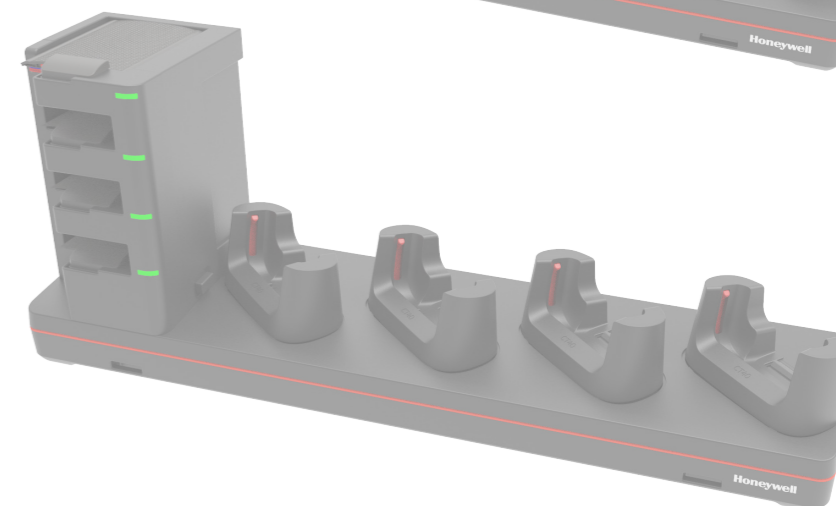
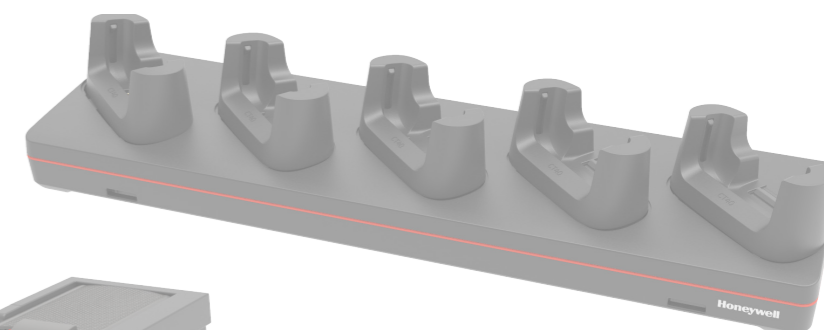
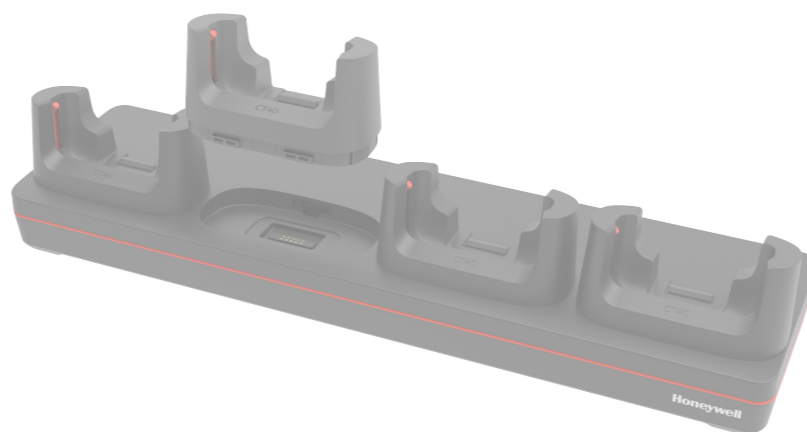
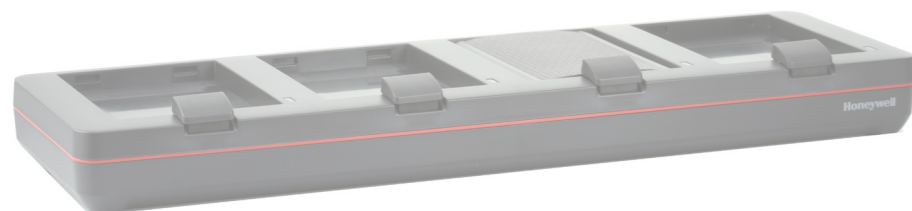

**PART NUMBER DESCRIPTION**

50121666-001 Power Adapter,12V 3A, No Power Cord, Compatible with CT40 Homebase / eHomebase / Quad Battery Charger (Requires IEC C13 AC Power Cord)

**PART NUMBER DESCRIPTION**

50121667-001 Power Adapter,12V 7A, No Power Cord, CT40 Quad Chargebase/ Quad Netbase (Requires IEC C13 AC Power Cord)

**PART NUMBER DESCRIPTION**

3007-3408-001 Power Supply 12V 8.3A R7B ADS-120QL-12-3 120100E 5-Bay Charge Base (Requires IEC C5 AC Power Cord)

# MISCELLANEOUS

## Optional Parts



| PART NUMBER | DESCRIPTION   |
|-------------|---|
| CT40-UCP-N  | CT40 <b>Non-Booted</b> universal cup, to be used for CT40 without protective boot |



| PART NUMBER | DESCRIPTION  |
|-------------|--|
| CT40-UCP-B  | CT40 <b>Booted</b> universal cup, to be used for CT40 with protective boot (CT45-PB-1) |



| PART NUMBER | DESCRIPTION  |
|-------------|--|
| CT45-VD-IST | CT45 Vehicle dock plastic insert, can be used along with CT40-VD-CNV and CT45-VD-CNV |



Batteries not included.

| PART NUMBER  | DESCRIPTION  |
|--------------|--|
| CT45-BAT-CUP | CT45/CT40 Universal Battery Cup<br>Compatible CT45-5CB-UVN-BAT-0, CT45-5CB-UVB-BAT-0 and CT4X-QBC-1BAY-0 |

# MISCELLANEOUS

## Optional Parts



| PART NUMBER | DESCRIPTION                   |
|-------------|-------------------------------|
| 825-237-001 | POUCH, CT40/CT50/CT60/CT60 XP |

| PART NUMBER | DESCRIPTION                    |
|-------------|--------------------------------|
| 825-238-001 | CT40/CT50/CT60/CT60 XP Holster |

# MISCELLANEOUS

## Micro-SD Cards

Honeywell Recommended – ATP Industrial Grade Micro SD Cards

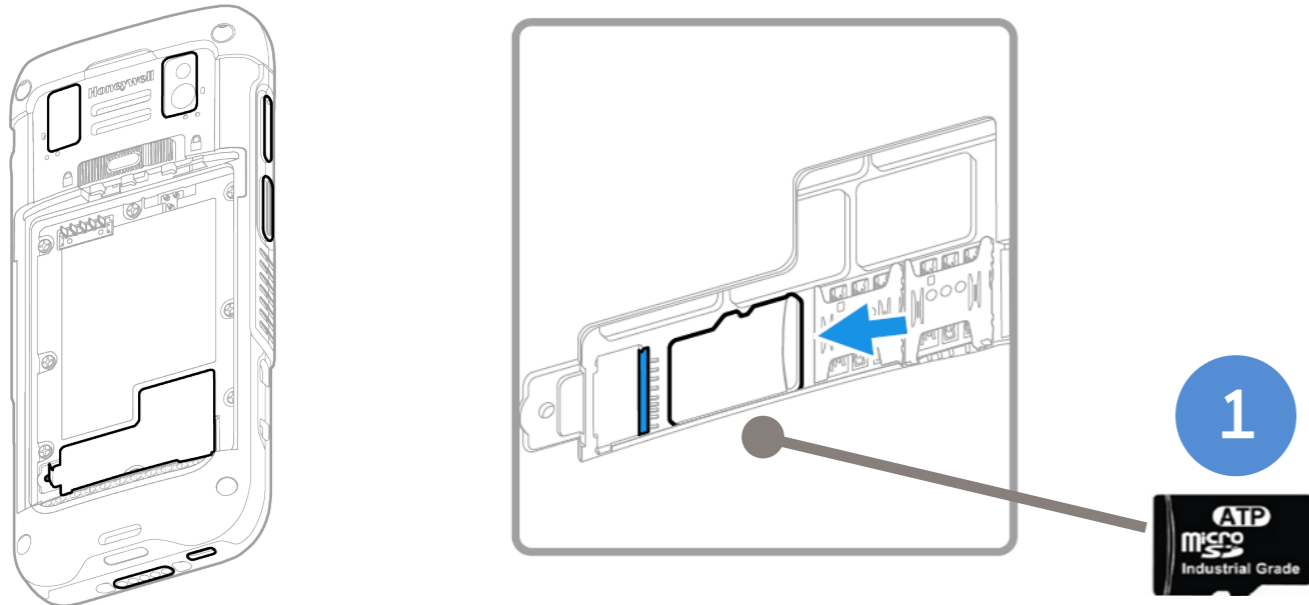

Why ATP Industrial Grade SD?

ATP's SIP (System-In-Packaging) manufacturing process encapsulates all exposed components and points of failure to ensure the products are fully waterproof, shockproof, and ESD (Electro-Static Discharge) proof. ATP Industrial Grade SD/SDHC Cards can withstand at least an operating/storage temperature range of at least -40 to 85 degrees Celsius. In addition to this temperature range, the cards are completely waterproof, dustproof, and ESD (Electro-Static Discharge) proof. All ATP Industrial Grade SD/SDHC cards are produced under a stringent RoHS and Green Package compliant manufacturing process to guarantee a consistent high level of build quality and performance. ATP Industrial SD cards deliver outstanding performance with read speed (seq) up to 18MB/sec and write speed (seq) up to 16MB/sec. All ATP Industrial Grade CF, SD, USB drives, and SSDs are constructed using best-in-class SLC(Single-Level Cell) components with enhanced Error Correction Code(ECC) functions and wear levelling algorithms. This results in MTBF ratings over 2 million hours and the highest write cycle lifetimes in the industry.

|           | PART NUMBER | DESCRIPTION                               |
|-----------|-------------|---|
| <b>1</b>  | 856-065-004 | MICRO-SD CARD, <b>1GB</b> , AFIGUDI, ROHS |
| <b>OR</b> | 856-065-005 | MICRO-SD CARD, <b>2GB</b> , AFIGUDI, ROHS |
| <b>OR</b> | 856-065-006 | MICRO-SD CARD, <b>4GB</b> , AFIGUDI, ROHS |
| <b>OR</b> | 856-065-007 | MICRO-SD CARD, <b>8GB</b> , AFIGUDI, ROHS |

## AC Cords

Regional Power Cords



AC Power - C13 Type Connector

| PART NUMBER  | DESCRIPTION   |
|--------------|---|
| 50117501-001 | POWER CORD AUSTRALIA 2500MM,SLED CB   |
| 321-501-002  | AC Power Cord, Denmark RoHS   |
| 77900508E    | Cable: power cord, power supply to AC outlet, straight, Power cord, Europe EU, IEC320-C13, 2.5 m (8.2 ft) |
| 321-502-002  | AC Power Cord, India/South Africa RoHS  |
| 321-500-002  | AC Power Cord, Japan RoHS   |
| 9000093CABLE | AC POWER CABLE, C14 TYPE, SWITZERLAND 3-PIN   |
| 77900507E    | Cable: power cord, power supply to AC outlet, straight - Power cord, UK, IEC320-C13, 2.5 m (8.2 ft)       |
| 1-974028-025 | AC Power Cord, US RoHS  |



AC Power - C5 Type Connector

| PART NUMBER   | DESCRIPTION                    |
|---------------|--------------------------------|
| 3007-4681-001 | C5 type power cable, USA       |
| 3007-4683-001 | C5 type power cable, Europe    |
| 3007-4682-001 | C5 type power cable, UK        |
| 3007-4684-001 | C5 type power cable, Australia |

# MISCELLANEOUS

## Disclaimer

---

Honeywell International Inc. (“HII”) reserves the right to make changes in specification and other information contained in this document without prior notice, and the reader should in all cases consult HII to determine whether any such changes have been made. The information in this publication does not represent a commitment on the part of HII.

HII shall not be liable for technical or editorial errors or omissions contained herein; nor for incidental or consequential damages resulting the furnishing, performance, or use of this material.

This document contains proprietary information that is protected by copyright. All rights are reserved. No part of this document may be photocopied, reproduced, or translated into another language with-out prior written consent of HII.

Web Address: [www.honeywellaidc.com](http://www.honeywellaidc.com)

The Bluetooth trademarks are owned by Bluetooth SIG, Inc., U.S.A and licensed to Honeywell.

Thor and Mobility Edge are trademarks or registered trademarks of Honeywell International Inc. in the United States and/or other countries.

Android is a trademark or registered trademark of Google Inc. in the United States and/or other countries. Windows is a trademark or registered trademark of Microsoft Corporation.

Qualcomm and Snapdragon are trademarks or registered trademarks of Qualcomm Incorporated in the United States and/or other countries.

Other product names mentioned in the manual may be trademarks of registered trademarks of their respective companies and are the property of their respective owners.

All rights reserved.

### For more information

[sps.honeywell.com](http://sps.honeywell.com)

### Honeywell Safety and Productivity Solutions

300 S Tryon St Suite 500

Charlotte, NC 28202

800-582-4263

[www.honeywell.com](http://www.honeywell.com)